

LOT 901 MACADAMINA CIRCUIT, MEDOWIE



MASTER PLAN



STAGE PLAN



PRELIMINARY SITE ANALYSIS PLAN

SCALE 1:250 @ A4

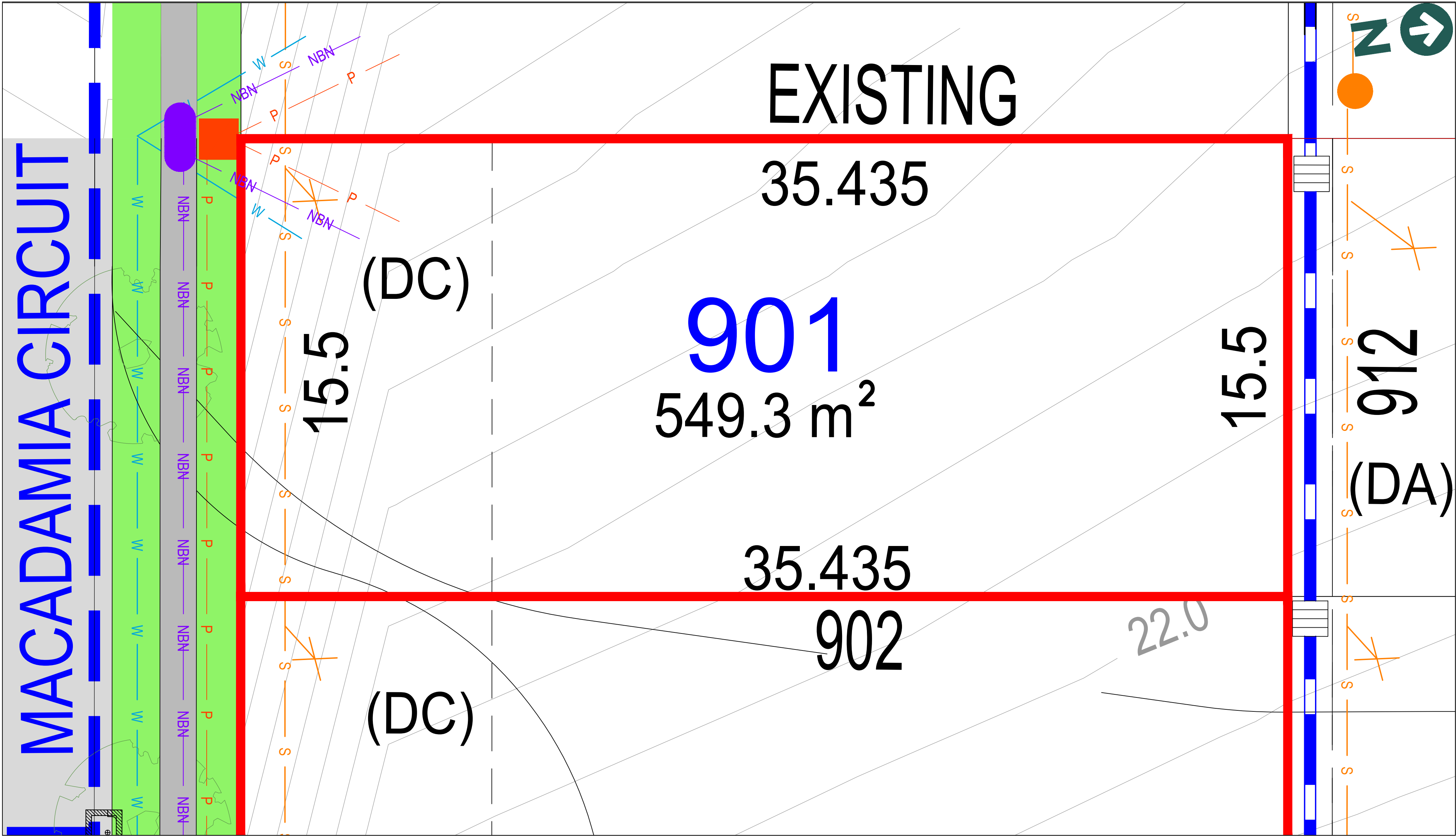
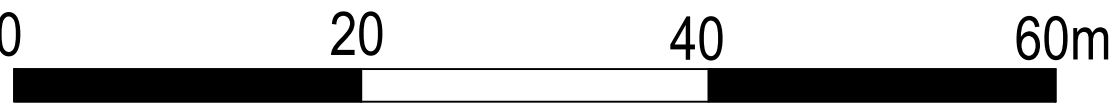

LEGEND:

- TELSTRA /NBN PIT
- HYDRANT
- STOP VALVE
- SEWER MANHOLE
- LIGHT POLE
- KERB INLET PIT
- STORMWATER PIT
- ELECTRICITY PILLAR
- ELECTRICAL SUBSTATION
- STREET TREES

STORMWATER PIPE

SEWER JUNCTION

SEWER MAIN

WATER MAIN

TELSTRA /NBN

UNDER GROUND POWER

Anticipated Site Classification - H1 Class
(to be confirmed at completion of construction)

(DA) EASEMENT TO DRAIN WATER 1.5m WIDE

(BDA) AREA BENEFITED EASEMENT TO DRAIN WATER 1.5m WIDE

(DC) RESTRICTION ON THE USE OF LAND (8.5 WIDE)

DISCLAIMER/ NOTES:

1.

Contours are based on finished design levels and are subject to construction and Council certification and therefore should not be considered as final or as-built.
2.

Location of utility services including but not limited to power, water, sewer, communications and gas are subject to construction and Supply Authority certification and therefore should not be considered as final or as-built.
3.

Survey information such as boundary dimensions and areas, easements etc are subject to Final Survey. Purchasers should refer to the Deposited Plan and 88B Instrument contained in the Contract for Sale of Land for further detailed information.
4.

Bushfire and Geotechnical classification are provided for convenience. Purchasers should refer to referenced detail specialist reports.
5.

This Preliminary Site Analysis Plan has been collated from various sources of design information and is provided for convenience to assist Purchasers in obtaining quotations/tenders for dwelling construction.
6.

This document does not form part of the Contract of Sale of the Land.

REVISION/S: HD213 STAGE 9 MARKETING r1

DATE: 17th OF MAY 2021

BY: HIGH DEFINITION DESIGN PTY LTD

LOT 902, MACADAMIA CIRCUIT, MEDOWIE

MASTER PLAN



STAGE PLAN

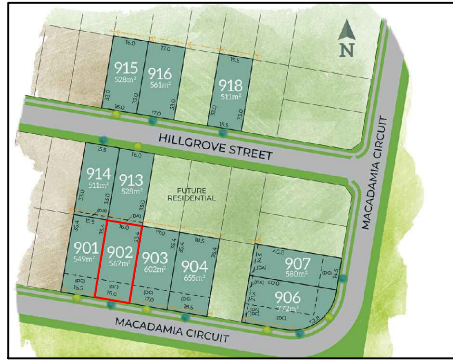

PRELIMINARY SITE ANALYSIS PLAN

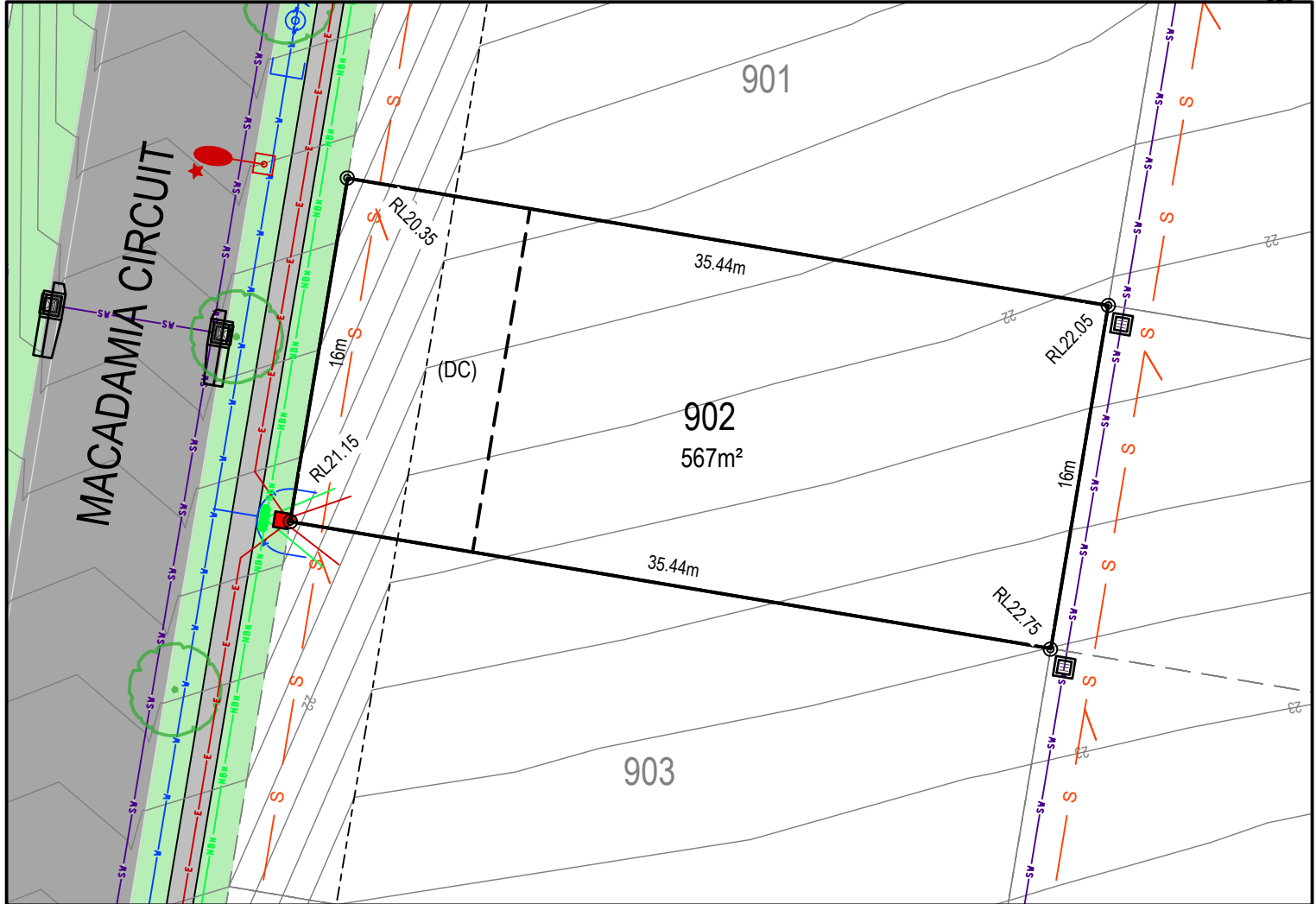

LEGEND:

- BATTER INTERFACE
- RETAINING WALL
- STORMWATER PIT
- SV --- STORMWATER PIPE
- S --- SEWERMAIN
- SEWER MAINTENANCE STRUCTURE
- S --- SEWER JUNCTION
- W --- WATERMAIN
- X --- HYDRANT, STOP VALVE
- NBW --- TELSTRA / NBN
- TELSTRA / NBN PIT
- UNDER GROUND POWER
- ELECTRICITY PILLAR
- ELECTRICAL EASEMENT
- LIGHT POLE
- RESTRICTION ON THE USE OF LAND
- STREET TREES
- ASSET PROTECTION ZONE BDY
- 0.25m CONTOURS

DISCLAIMER/ NOTES:

1. Contours are based on finished design levels and are subject to construction and Council certification and therefore should not be considered as final or as-built.
2. Location of utility services including but not limited to power, water, sewer, communications and gas are subject to construction and supply authority certification and therefore should not be considered as final or as-built.
3. Survey information such as boundary dimensions and areas, easements etc are subject to final survey. Purchasers should refer to the deposited plan and 88B instrument contained in the contract for sale of land for further detailed information.
4. Bushfire and geotechnical classification are provided for convenience. Purchasers should refer to referenced detail specialist reports.
5. This preliminary site analysis plan has been collated from various sources of design information and is provided for convenience to assist purchasers in obtaining quotations/ tenders for dwelling construction.
6. This document does not form part of the contract of sale of the land.
7. Anticipated site classification is H2 or better (to be confirmed at completion of construction).

(DA) - EASEMENT TO DRAIN WATER 1.5 WIDE
(DB) - RESTRICTION ON USE OF LAND 0.9 WIDE
(DC) - RESTRICTION ON THE USE OF LAND 8.5 WIDE

REVISION/S: HD213 STAGE 9 MARKETING r1
DATE: 16 JULY 2021
BY: ACOR CONSULTANTS PTY LTD

LOT 903, MACADAMIA CIRCUIT, MEDOWIE

MASTER PLAN



STAGE PLAN

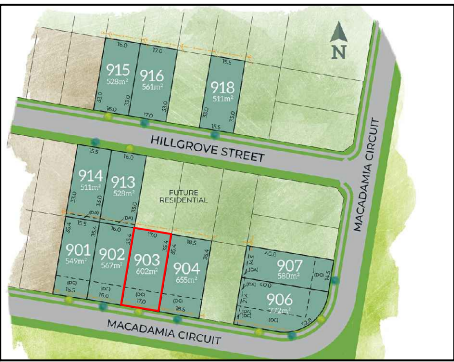

PRELIMINARY SITE ANALYSIS PLAN

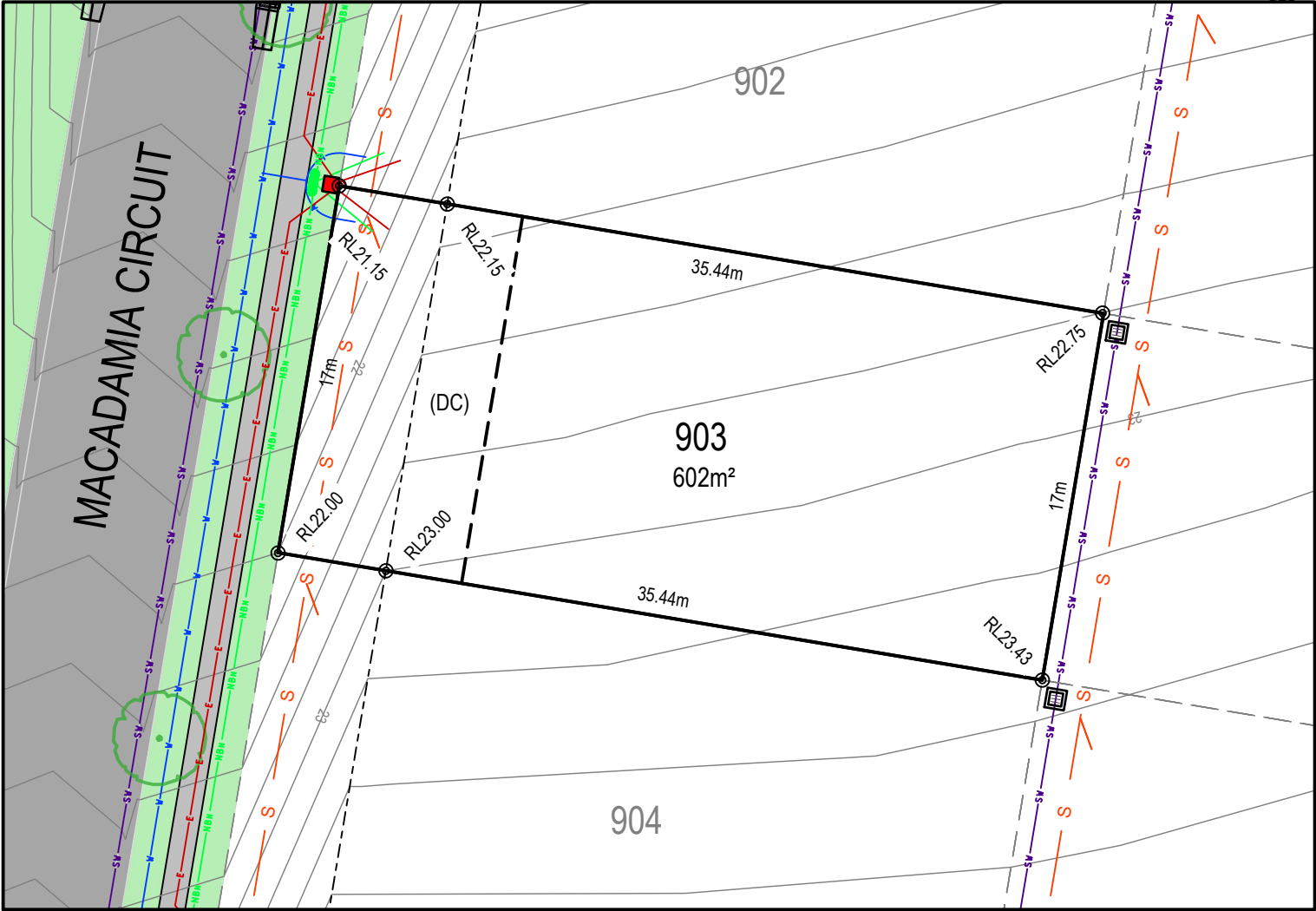

- LEGEND:**
- BATTER INTERFACE
 - RETAINING WALL
 - STORMWATER PIT
 - STORMWATER PIPE
 - SEWER MAIN
 - SEWER MAINTENANCE STRUCTURE
 - SEWER JUNCTION
 - WATER MAIN
 - HYDRANT, STOP VALVE
 - TELSTRA / NBN
 - TELSTRA / NBN PIT
 - UNDER GROUND POWER
 - ELECTRICITY PILLAR
 - ELECTRICAL EASEMENT
 - LIGHT POLE
 - RESTRICTION ON THE USE OF LAND
 - STREET TREES
 - ASSET PROTECTION ZONE BDY
 - 0.25m CONTOURS

DISCLAIMER/ NOTES:

1. Contours are based on finished design levels and are subject to construction and Council certification and therefore should not be considered as final or as-built.
2. Location of utility services including but not limited to power, water, sewer, communications and gas are subject to construction and supply authority certification and therefore should not be considered as final or as-built.
3. Survey information such as boundary dimensions and areas, easements etc are subject to final survey. Purchasers should refer to the deposited plan and 88B instrument contained in the contract for sale of land for further detailed information.
4. Bushfire and geotechnical classification are provided for convenience. Purchasers should refer to referenced detail specialist reports.
5. This preliminary site analysis plan has been collated from various sources of design information and is provided for convenience to assist purchasers in obtaining quotations/ tenders for dwelling construction.
6. This document does not form part of the contract of sale of the land.
7. Anticipated site classification is H2 or better (to be confirmed at completion of construction).

(DA) - EASEMENT TO DRAIN WATER 1.5 WIDE
(DB) - RESTRICTION ON USE OF LAND 0.9 WIDE
(DC) - RESTRICTION ON THE USE OF LAND 8.5 WIDE

REVISION/S: HD213 STAGE 9 MARKETING r1
DATE: 16 JULY 2021
BY: ACOR CONSULTANTS PTY LTD

LOT 904 MACADAMINA CIRCUIT, MEDOWIE



MASTER PLAN



STAGE PLAN



PRELIMINARY SITE ANALYSIS PLAN

SCALE 1:250 @ A4

0 20 40 60m

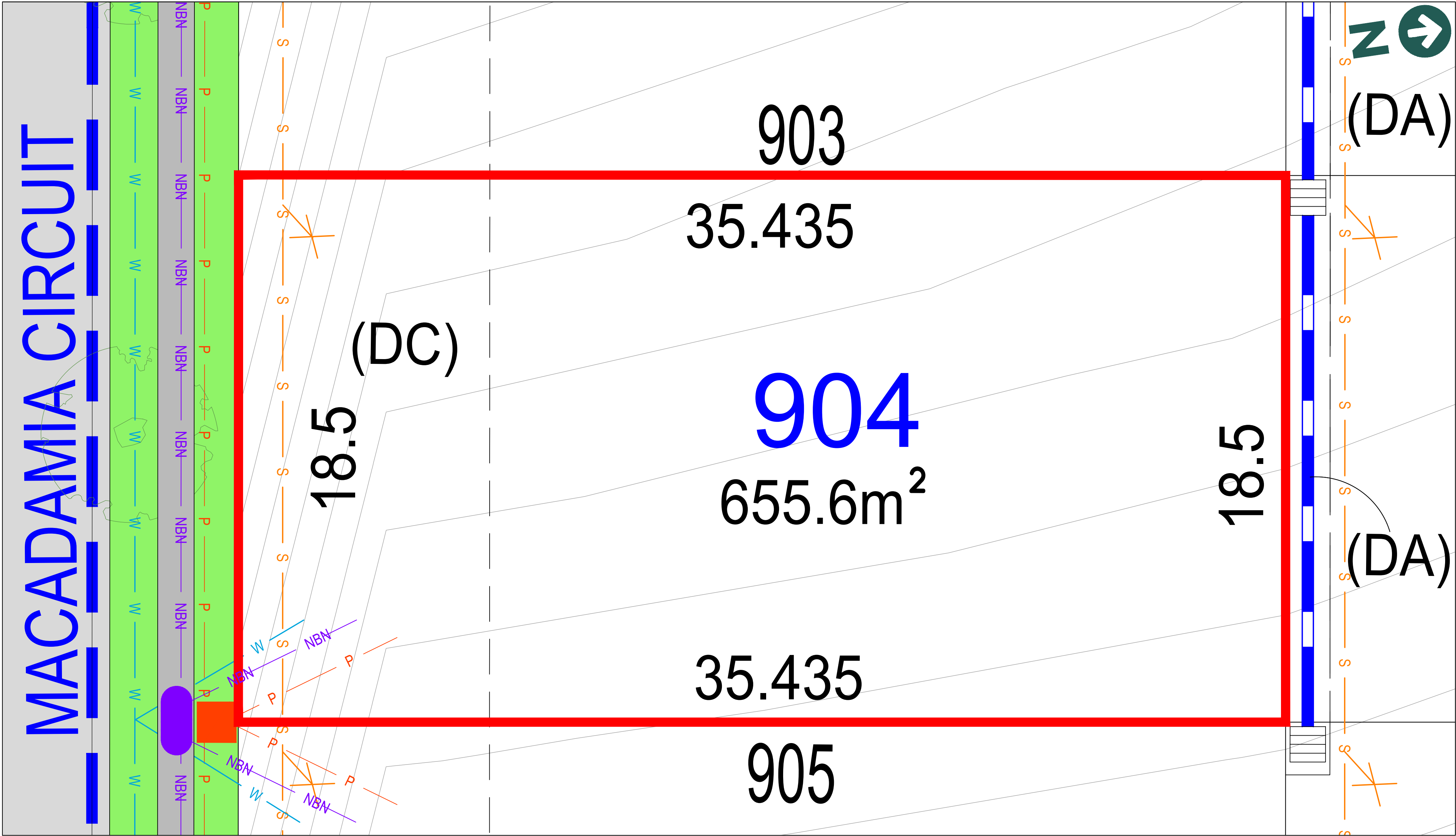

LEGEND:

- TELSTRA /NBN PIT
- HYDRANT
- STOP VALVE
- SEWER MANHOLE
- LIGHT POLE
- KERB INLET PIT
- STORMWATER PIT
- ELECTRICITY PILLAR
- ELECTRICAL SUBSTATION
- STREET TREES
- STORMWATER PIPE
- SEWER JUNCTION
- SEWER MAIN
- WATER MAIN
- TELSTRA /NBN
- UNDER GROUND POWER
- Anticipated Site Classification - H1 Class (to be confirmed at completion of construction)
- (DA) EASEMENT TO DRAIN WATER 1.5m WIDE
- (BDA) AREA BENEFITED EASEMENT TO DRAIN WATER 1.5m WIDE
- (DC) RESTRICTION ON THE USE OF LAND (8.5 WIDE)

DISCLAIMER/ NOTES:

- Contours are based on finished design levels and are subject to construction and Council certification and therefore should not be considered as final or as-built.
- Location of utility services including but not limited to power, water, sewer, communications and gas are subject to construction and Supply Authority certification and therefore should not be considered as final or as-built.
- Survey information such as boundary dimensions and areas, easements etc are subject to Final Survey. Purchasers should refer to the Deposited Plan and 88B Instrument contained in the Contract for Sale of Land for further detailed information.
- Bushfire and Geotechnical classification are provided for convenience. Purchasers should refer to referenced detail specialist reports.
- This Preliminary Site Analysis Plan has been collated from various sources of design information and is provided for convenience to assist Purchasers in obtaining quotations/tenders for dwelling construction.
- This document does not form part of the Contract of Sale of the Land.

REVISION/S: HD213 STAGE 9 MARKETING r1

DATE: 17th OF MAY 2021

BY: HIGH DEFINITION DESIGN PTY LTD

LOT 905, MACADAMIA CIRCUIT, MEDOWIE

MASTER PLAN



STAGE PLAN

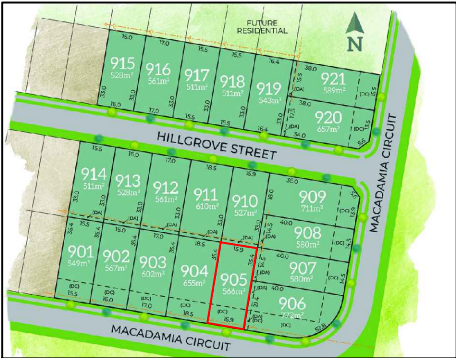

PRELIMINARY SITE ANALYSIS PLAN

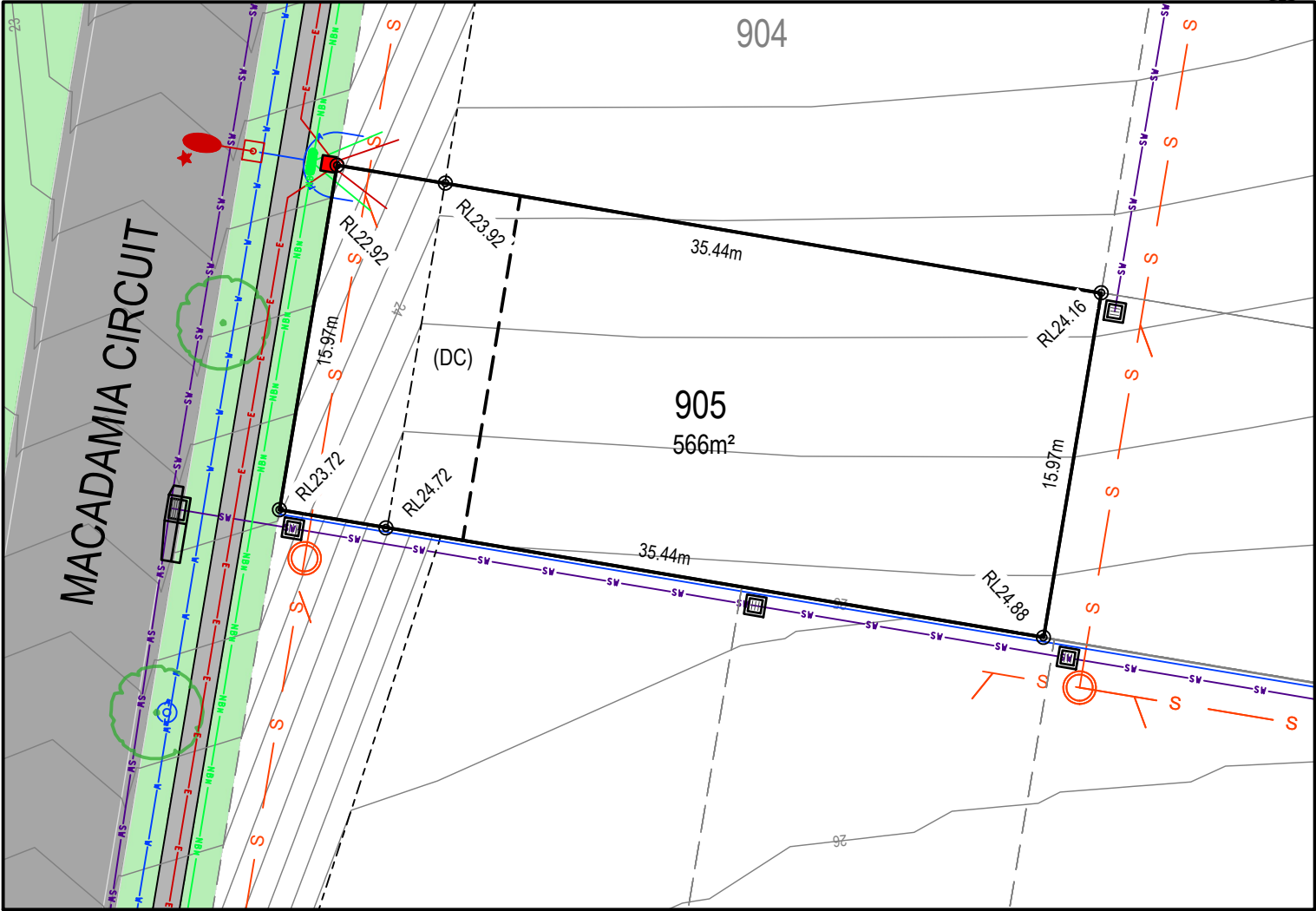

- LEGEND:**
- BATTER INTERFACE
 - RETAINING WALL
 - STORMWATER PIT
 - STORMWATER PIPE
 - SEWERMAIN
 - SEWER MAINTENANCE STRUCTURE
 - SEWER JUNCTION
 - WATERMAIN
 - HYDRANT, STOP VALVE
 - TELSTRA / NBN
 - TELSTRA / NBN PIT
 - UNDER GROUND POWER
 - ELECTRICITY PILLAR
 - ELECTRICAL EASEMENT
 - LIGHT POLE
 - RESTRICTION ON THE USE OF LAND
 - STREET TREES
 - ASSET PROTECTION ZONE BDY
 - 0.25m CONTOURS

DISCLAIMER/ NOTES:

- Contours are based on finished design levels and are subject to construction and Council certification and therefore should not be considered as final or as-built.
- Location of utility services including but not limited to power, water, sewer, communications and gas are subject to construction and supply authority certification and therefore should not be considered as final or as-built.
- Survey information such as boundary dimensions and areas, easements etc are subject to final survey. Purchasers should refer to the deposited plan and 88B instrument contained in the contract for sale of land for further detailed information.
- Bushfire and geotechnical classification are provided for convenience. Purchasers should refer to referenced detail specialist reports.
- This preliminary site analysis plan has been collated from various sources of design information and is provided for convenience to assist purchasers in obtaining quotations/ tenders for dwelling construction.
- This document does not form part of the contract of sale of the land.
- Anticipated site classification is H2 or better (to be confirmed at completion of construction).

(DA) - EASEMENT TO DRAIN WATER 1.5 WIDE
(DB) - RESTRICTION ON USE OF LAND 0.9 WIDE
(DC) - RESTRICTION ON THE USE OF LAND 8.5 WIDE

REVISION/S: HD213 STAGE 9 MARKETING r1
DATE: 29th JULY 2021
BY: ACOR CONSULTANTS PTY LTD

LOT 906 MACADAMINA CIRCUIT, MEDOWIE



MASTER PLAN



STAGE PLAN



PRELIMINARY SITE ANALYSIS PLAN

SCALE 1:300 @ A4

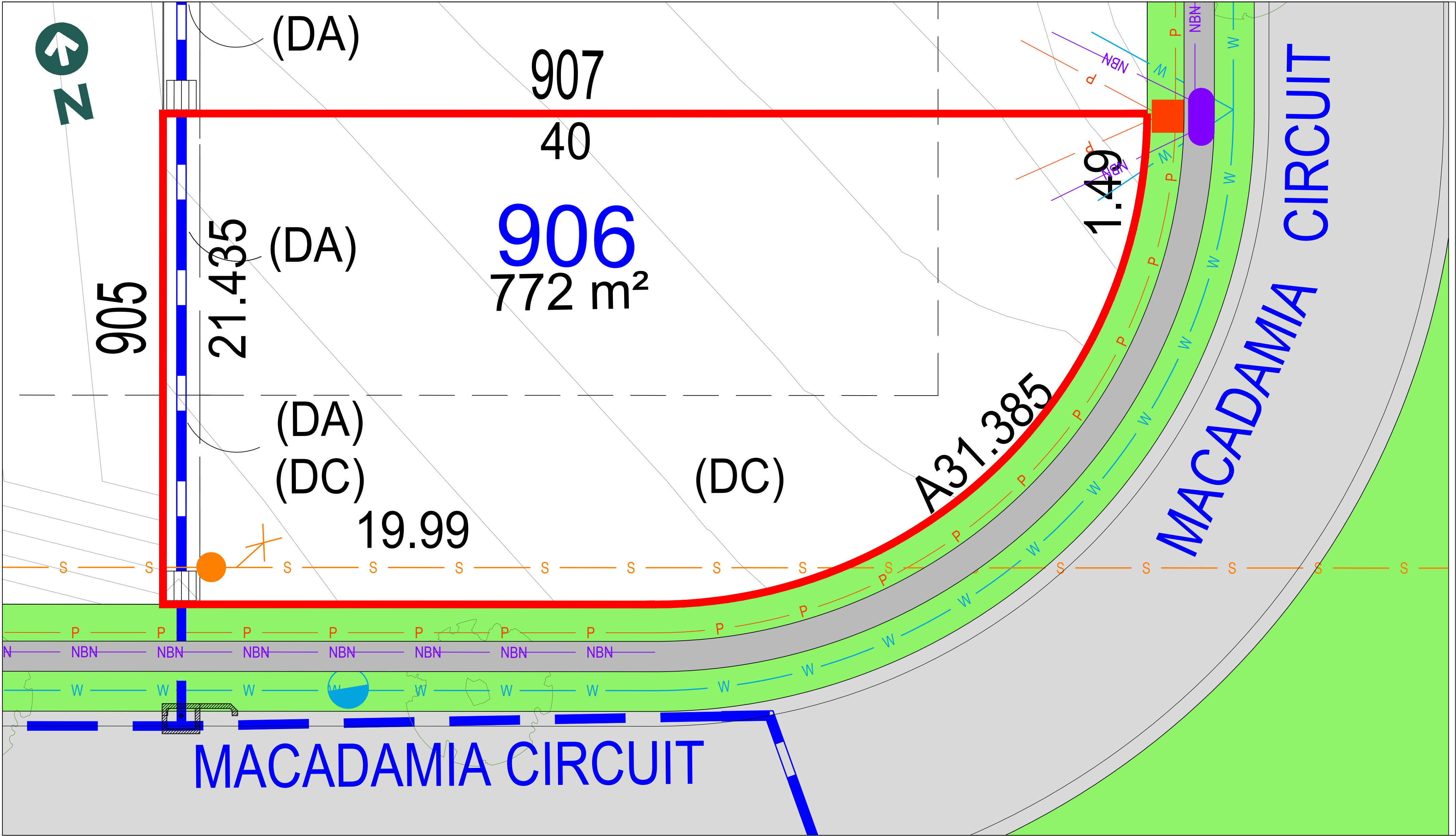

LEGEND:

- TELSTRA /NBN PIT
- HYDRANT
- STOP VALVE
- SEWER MANHOLE
- LIGHT POLE
- KERB INLET PIT
- STORMWATER PIT
- ELECTRICITY PILLAR
- ELECTRICAL SUBSTATION
- STREET TREES

STORMWATER PIPESEWER JUNCTIONSEWER MAINWATER MAINTELSTRA /NBNUNDER GROUND POWER

Anticipated Site Classification - H1 Class
(to be confirmed at completion of construction)

(DA) EASEMENT TO DRAIN WATER 1.5m WIDE

(BDA) AREA BENEFITED EASEMENT TO DRAIN WATER 1.5m WIDE

(DC) RESTRICTION ON THE USE OF LAND (8.5 WIDE)

DISCLAIMER/ NOTES:

1.

Contours are based on finished design levels and are subject to construction and Council certification and therefore should not be considered as final or as-built.
2.

Location of utility services including but not limited to power, water, sewer, communications and gas are subject to construction and Supply Authority certification and therefore should not be considered as final or as-built.
3.

Survey information such as boundary dimensions and areas, easements etc are subject to Final Survey. Purchasers should refer to the Deposited Plan and 88B Instrument contained in the Contract for Sale of Land for further detailed information.
4.

Bushfire and Geotechnical classification are provided for convenience. Purchasers should refer to referenced detail specialist reports.
5.

This Preliminary Site Analysis Plan has been collated from various sources of design information and is provided for convenience to assist Purchasers in obtaining quotations/tenders for dwelling construction.
6.

This document does not form part of the Contract of Sale of the Land.

REVISION/S: HD213 STAGE 9 MARKETING r1

DATE: 17th OF MAY 2021

BY: HIGH DEFINITION DESIGN PTY LTD

LOT 907 MACADAMINA CIRCUIT, MEDOWIE



MASTER PLAN



STAGE PLAN



PRELIMINARY SITE ANALYSIS PLAN

SCALE 1:300 @ A4

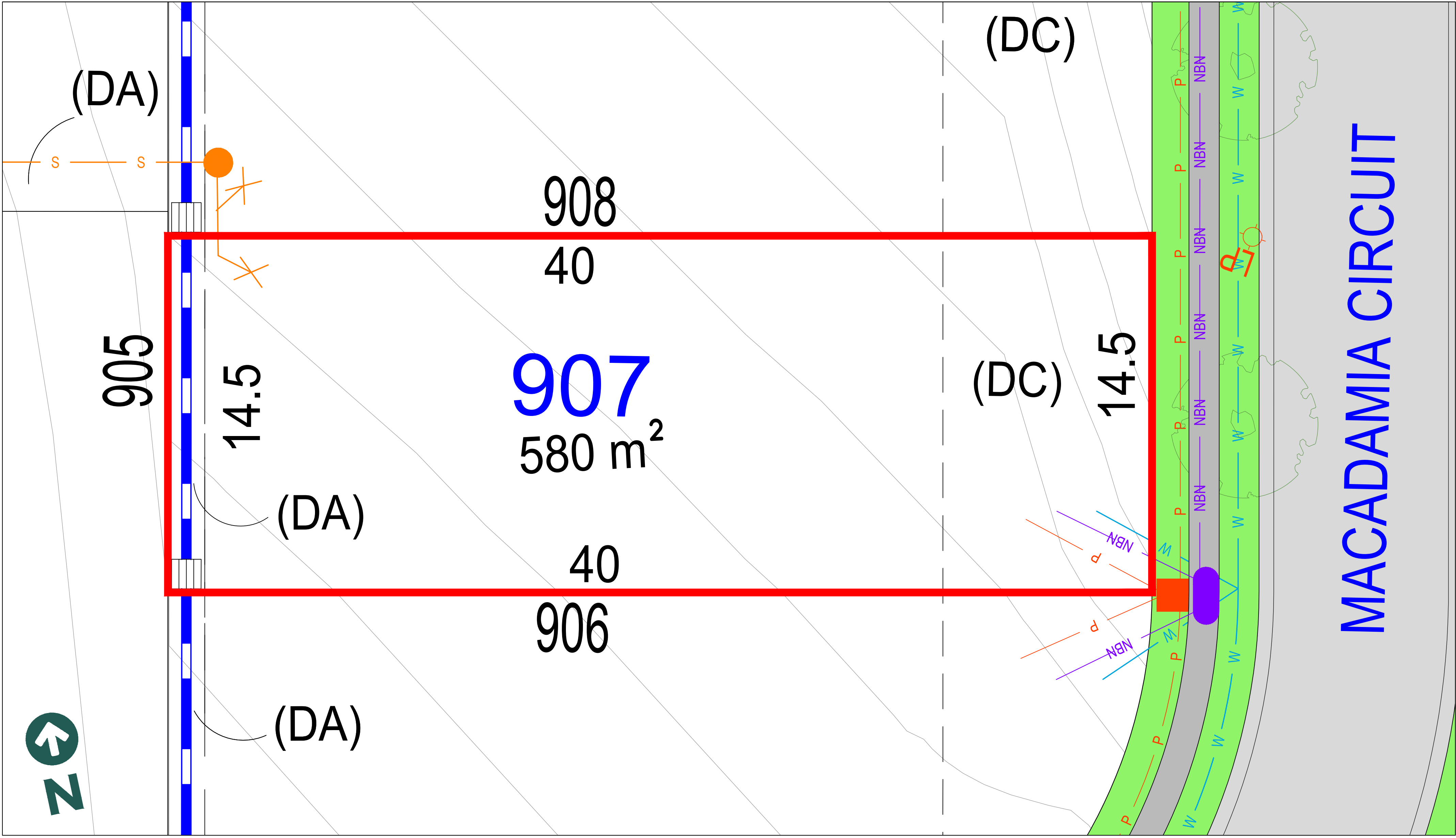

LEGEND:

- TELSTRA /NBN PIT
- HYDRANT
- STOP VALVE
- SEWER MANHOLE
- LIGHT POLE
- KERB INLET PIT
- STORMWATER PIT
- ELECTRICITY PILLAR
- ELECTRICAL SUBSTATION
- STREET TREES
- STORMWATER PIPE
- SEWER JUNCTION
- SEWER MAIN
- WATER MAIN
- TELSTRA /NBN
- UNDER GROUND POWER

Anticipated Site Classification - H1 Class
(to be confirmed at completion of construction)

(DA) EASEMENT TO DRAIN WATER 1.5m WIDE

(BDA) AREA BENEFITED EASEMENT TO DRAIN WATER 1.5m WIDE

(DC) RESTRICTION ON THE USE OF LAND (8.5 WIDE)

DISCLAIMER/ NOTES:

1.

Contours are based on finished design levels and are subject to construction and Council certification and therefore should not be considered as final or as-built.
2.

Location of utility services including but not limited to power, water, sewer, communications and gas are subject to construction and Supply Authority certification and therefore should not be considered as final or as-built.
3.

Survey information such as boundary dimensions and areas, easements etc are subject to Final Survey. Purchasers should refer to the Deposited Plan and 88B Instrument contained in the Contract for Sale of Land for further detailed information.
4.

Bushfire and Geotechnical classification are provided for convenience. Purchasers should refer to referenced detail specialist reports.
5.

This Preliminary Site Analysis Plan has been collated from various sources of design information and is provided for convenience to assist Purchasers in obtaining quotations/tenders for dwelling construction.
6.

This document does not form part of the Contract of Sale of the Land.

REVISION/S: HD213 STAGE 9 MARKETING r1

DATE: 17th OF MAY 2021

BY: HIGH DEFINITION DESIGN PTY LTD

LOT 908, MACADAMIA CIRCUIT, MEDOWIE

MASTER PLAN



STAGE PLAN

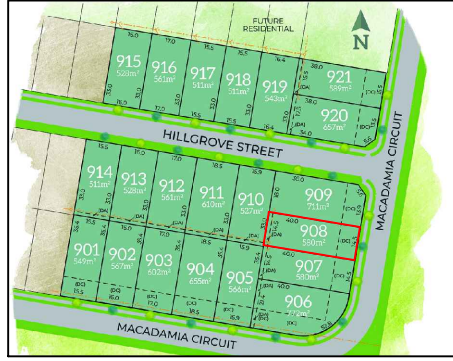

THE GARDENS
MEDOWIE



PRELIMINARY SITE ANALYSIS PLAN

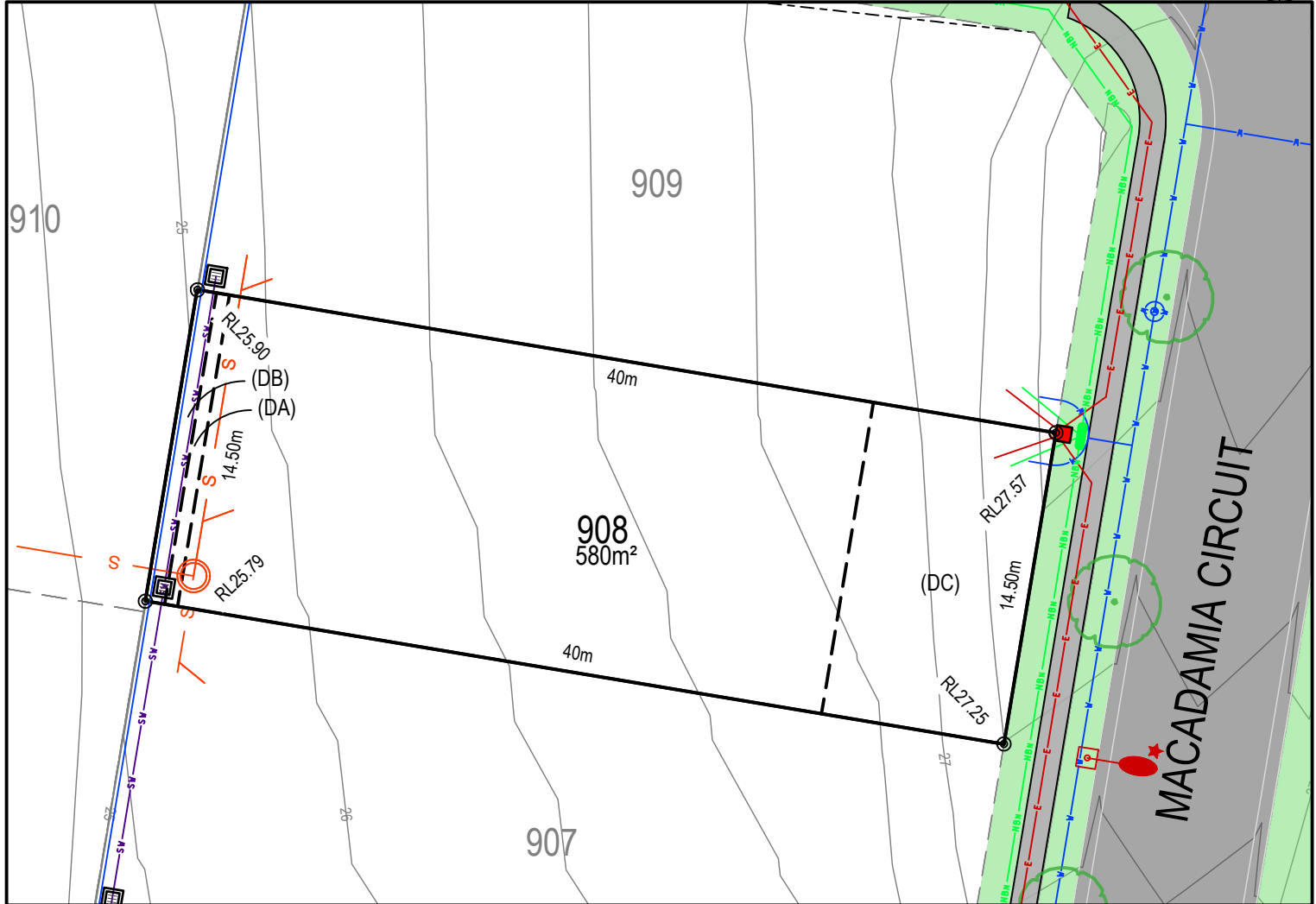

LEGEND:

- BATTER INTERFACE
- RETAINING WALL
- STORMWATER PIT
- SV --- STORMWATER PIPE
- S --- SEWERMAIN
- S --- SEWER MAINTENANCE STRUCTURE
- S --- SEWER JUNCTION
- W --- WATERMAIN
- O X --- HYDRANT, STOP VALVE
- NBW --- TELSTRA / NBN
- TELSTRA / NBN PIT
- E --- UNDER GROUND POWER
- ELECTRICITY PILLAR
- ELECTRICAL EASEMENT
- LIGHT POLE
- RESTRICTION ON THE USE OF LAND
- STREET TREES
- ASSET PROTECTION ZONE BDY
- 0.25m CONTOURS

DISCLAIMER/ NOTES:

1. Contours are based on finished design levels and are subject to construction and Council certification and therefore should not be considered as final or as-built.
2. Location of utility services including but not limited to power, water, sewer, communications and gas are subject to construction and supply authority certification and therefore should not be considered as final or as-built.
3. Survey information such as boundary dimensions and areas, easements etc are subject to final survey. Purchasers should refer to the deposited plan and 88B instrument contained in the contract for sale of land for further detailed information.
4. Bushfire and geotechnical classification are provided for convenience. Purchasers should refer to referenced detail specialist reports.
5. This preliminary site analysis plan has been collated from various sources of design information and is provided for convenience to assist purchasers in obtaining quotations/ tenders for dwelling construction.
6. This document does not form part of the contract of sale of the land.
7. Anticipated site classification is H2 or better (to be confirmed at completion of construction).

(DA) - EASEMENT TO DRAIN WATER 1.5 WIDE
(DB) - RESTRICTION ON USE OF LAND 0.9 WIDE
(DC) - RESTRICTION ON THE USE OF LAND 8.5 WIDE

REVISION/S: HD213 STAGE 9 MARKETING r1
DATE: 29th JULY 2021
BY: ACOR CONSULTANTS PTY LTD

thegardensmedowie.com.au



A QUALITY
MCCLOY
GROUP
PROJECT

LOT 909, MACADAMIA CIRCUIT, MEDOWIE

MASTER PLAN



STAGE PLAN

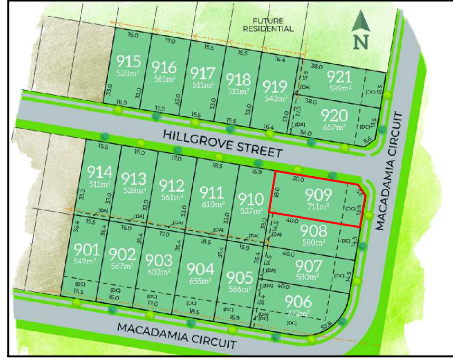

THE GARDENS
MEDOWIE

PRELIMINARY SITE ANALYSIS PLAN



LEGEND:

- BATTER INTERFACE
- RETAINING WALL
- STORMWATER PIT
- SV --- STORMWATER PIPE
- S --- SEWERMAIN
- S --- SEWER MAINTENANCE STRUCTURE
- S --- SEWER JUNCTION
- W --- WATERMAIN
- O X --- HYDRANT, STOP VALVE
- NBW --- TELSTRA / NBN
- NBW --- TELSTRA / NBN PIT
- E --- UNDER GROUND POWER
- E --- ELECTRICITY PILLAR
- E --- ELECTRICAL EASEMENT
- E --- LIGHT POLE
- E --- RESTRICTION ON THE USE OF LAND
- E --- STREET TREES
- E --- ASSET PROTECTION ZONE BDY
- E --- 0.25m CONTOURS

DISCLAIMER/ NOTES:

1. Contours are based on finished design levels and are subject to construction and Council certification and therefore should not be considered as final or as-built.
2. Location of utility services including but not limited to power, water, sewer, communications and gas are subject to construction and supply authority certification and therefore should not be considered as final or as-built.
3. Survey information such as boundary dimensions and areas, easements etc are subject to final survey. Purchasers should refer to the deposited plan and 88B instrument contained in the contract for sale of land for further detailed information.
4. Bushfire and geotechnical classification are provided for convenience. Purchasers should refer to referenced detail specialist reports.
5. This preliminary site analysis plan has been collated from various sources of design information and is provided for convenience to assist purchasers in obtaining quotations/ tenders for dwelling construction.
6. This document does not form part of the contract of sale of the land.
7. Anticipated site classification is H2 or better (to be confirmed at completion of construction).

(DA) - EASEMENT TO DRAIN WATER 1.5 WIDE
(DB) - RESTRICTION ON USE OF LAND 0.9 WIDE
(DC) - RESTRICTION ON THE USE OF LAND 8.5 WIDE

REVISION/S: HD213 STAGE 9 MARKETING r1
DATE: 29th JULY 2021
BY: ACOR CONSULTANTS PTY LTD

thegardensmedowie.com.au



A QUALITY
MCCLOY
GROUP
PROJECT

LOT 910, HILLGROVE STREET, MEDOWIE

MASTER PLAN



STAGE PLAN

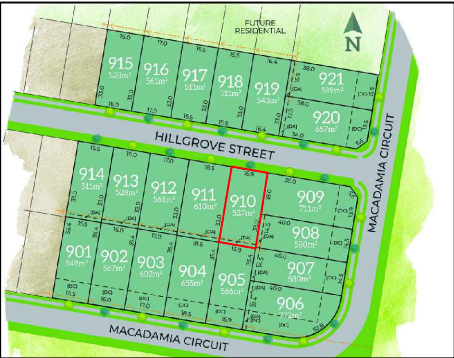

PRELIMINARY SITE ANALYSIS PLAN

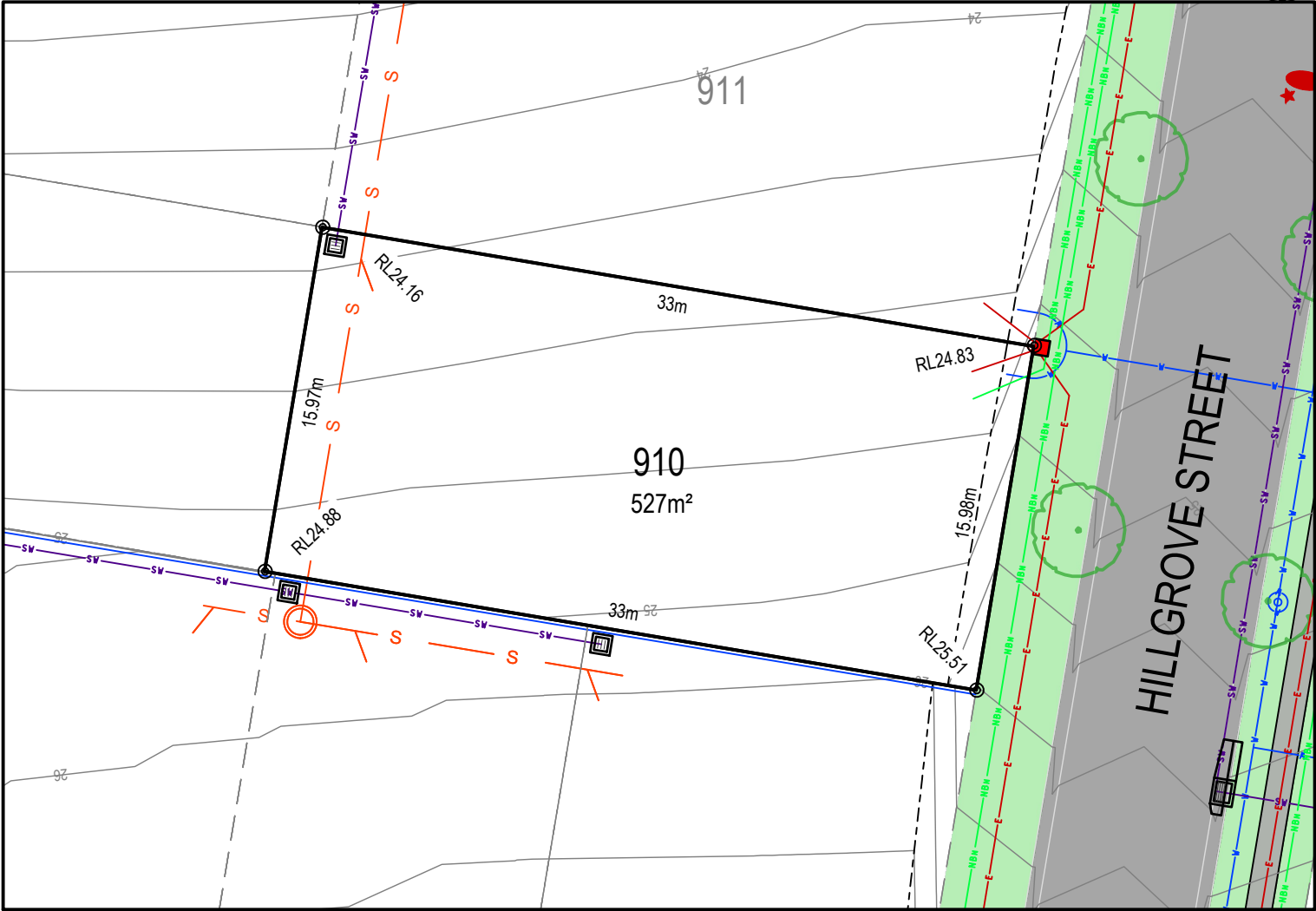

- LEGEND:**
- BATTER INTERFACE
 - RETAINING WALL
 - STORMWATER PIT
 - STORMWATER PIPE
 - SEWERMAIN
 - SEWER MAINTENANCE STRUCTURE
 - SEWER JUNCTION
 - WATERMAIN
 - HYDRANT, STOP VALVE
 - TELSTRA / NBN
 - TELSTRA / NBN PIT
 - UNDER GROUND POWER
 - ELECTRICITY PILLAR
 - ELECTRICAL EASEMENT
 - LIGHT POLE
 - RESTRICTION ON THE USE OF LAND
 - STREET TREES
 - ASSET PROTECTION ZONE BDY
 - 0.25m CONTOURS

DISCLAIMER/ NOTES:

- Contours are based on finished design levels and are subject to construction and Council certification and therefore should not be considered as final or as-built.
- Location of utility services including but not limited to power, water, sewer, communications and gas are subject to construction and supply authority certification and therefore should not be considered as final or as-built.
- Survey information such as boundary dimensions and areas, easements etc are subject to final survey. Purchasers should refer to the deposited plan and 88B instrument contained in the contract for sale of land for further detailed information.
- Bushfire and geotechnical classification are provided for convenience. Purchasers should refer to referenced detail specialist reports.
- This preliminary site analysis plan has been collated from various sources of design information and is provided for convenience to assist purchasers in obtaining quotations/ tenders for dwelling construction.
- This document does not form part of the contract of sale of the land.
- Anticipated site classification is H2 or better (to be confirmed at completion of construction).

(DA) - EASEMENT TO DRAIN WATER 1.5 WIDE
(DB) - RESTRICTION ON USE OF LAND 0.9 WIDE
(DC) - RESTRICTION ON THE USE OF LAND 8.5 WIDE

REVISION/S: HD213 STAGE 9 MARKETING r1
DATE: 29th JULY 2021
BY: ACOR CONSULTANTS PTY LTD

LOT 911, HILLGORVE STREET, MEDOWIE

MASTER PLAN



STAGE PLAN

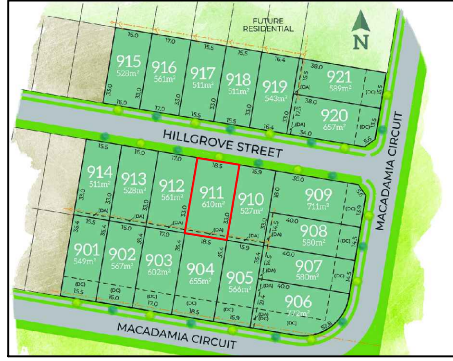

THE GARDENS
MEDOWIE

PRELIMINARY SITE ANALYSIS PLAN

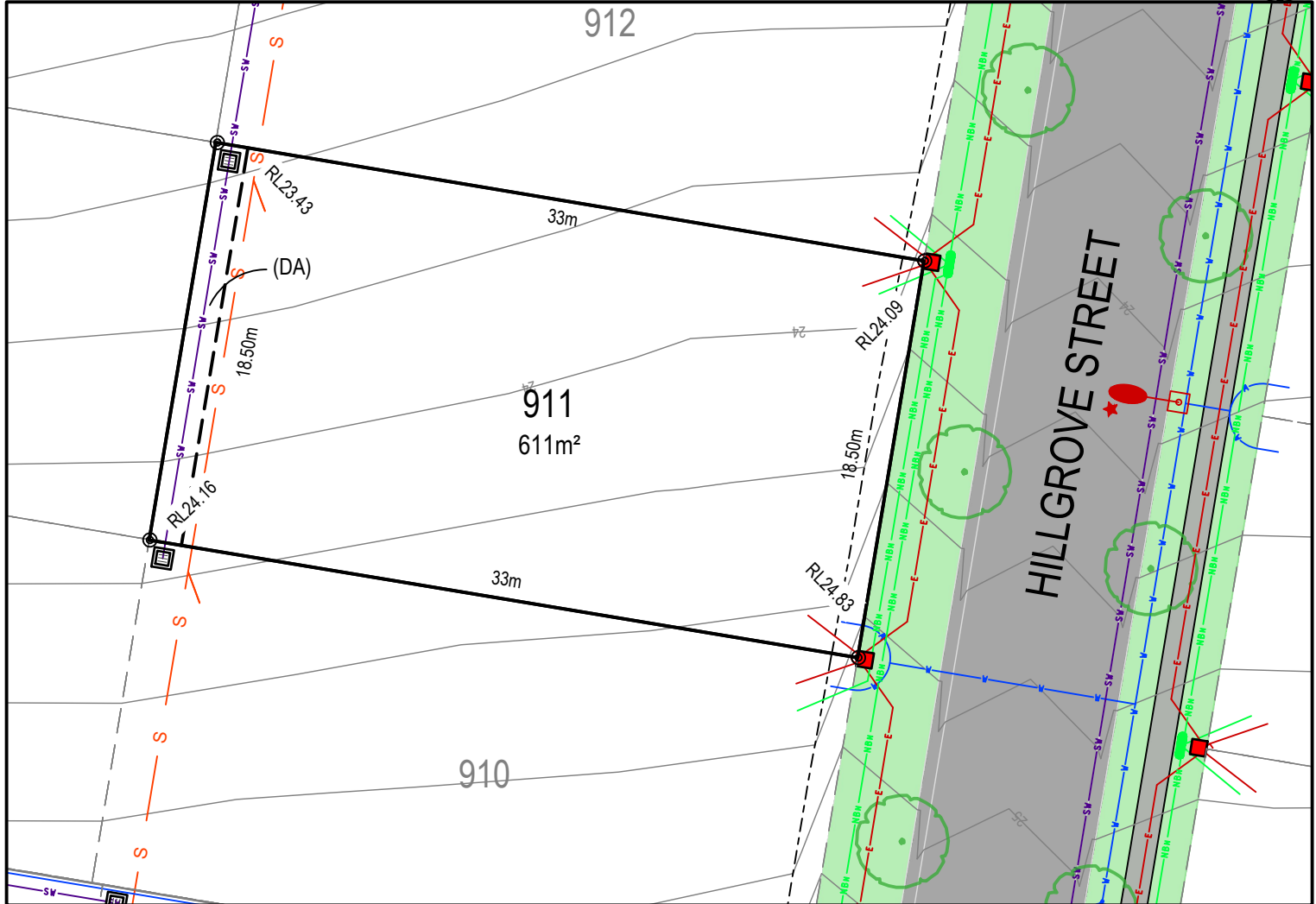

LEGEND:

- BATTER INTERFACE
- RETAINING WALL
- STORMWATER PIT
- SV --- STORMWATER PIPE
- S --- SEWERMAIN
- S --- SEWER MAINTENANCE STRUCTURE
- S --- SEWER JUNCTION
- W --- WATERMAIN
- O --- HYDRANT, STOP VALVE
- NBW --- TELSTRA / NBN
- NBW --- TELSTRA / NBN PIT
- E --- UNDER GROUND POWER
- E --- ELECTRICITY PILLAR
- E --- ELECTRICAL EASEMENT
- E --- LIGHT POLE
- R --- RESTRICTION ON THE USE OF LAND
- R --- STREET TREES
- R --- ASSET PROTECTION ZONE BDY
- R --- 0.25m CONTOURS

DISCLAIMER/ NOTES:

1. Contours are based on finished design levels and are subject to construction and Council certification and therefore should not be considered as final or as-built.
2. Location of utility services including but not limited to power, water, sewer, communications and gas are subject to construction and supply authority certification and therefore should not be considered as final or as-built.
3. Survey information such as boundary dimensions and areas, easements etc are subject to final survey. Purchasers should refer to the deposited plan and 88B instrument contained in the contract for sale of land for further detailed information.
4. Bushfire and geotechnical classification are provided for convenience. Purchasers should refer to referenced detail specialist reports.
5. This preliminary site analysis plan has been collated from various sources of design information and is provided for convenience to assist purchasers in obtaining quotations/ tenders for dwelling construction.
6. This document does not form part of the contract of sale of the land.
7. Anticipated site classification is H2 or better (to be confirmed at completion of construction).

(DA) - EASEMENT TO DRAIN WATER 1.5 WIDE
(DB) - RESTRICTION ON USE OF LAND 0.9 WIDE
(DC) - RESTRICTION ON THE USE OF LAND 8.5 WIDE

REVISION/S: HD213 STAGE 9 MARKETING r1

DATE: 29th JULY 2021

BY: ACOR CONSULTANTS PTY LTD

thegardensmedowie.com.au



A QUALITY
MCCLOY
GROUP
PROJECT

LOT 912, HILLGROVE STREET, MEDOWIE

MASTER PLAN



STAGE PLAN

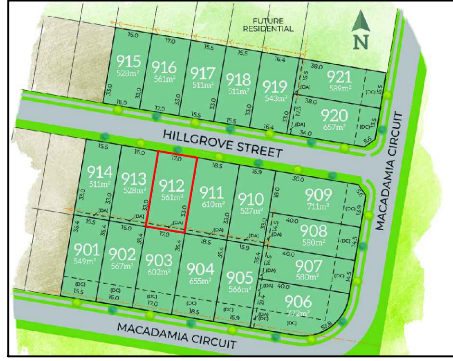

THE GARDENS
MEDOWIE

PRELIMINARY SITE ANALYSIS PLAN

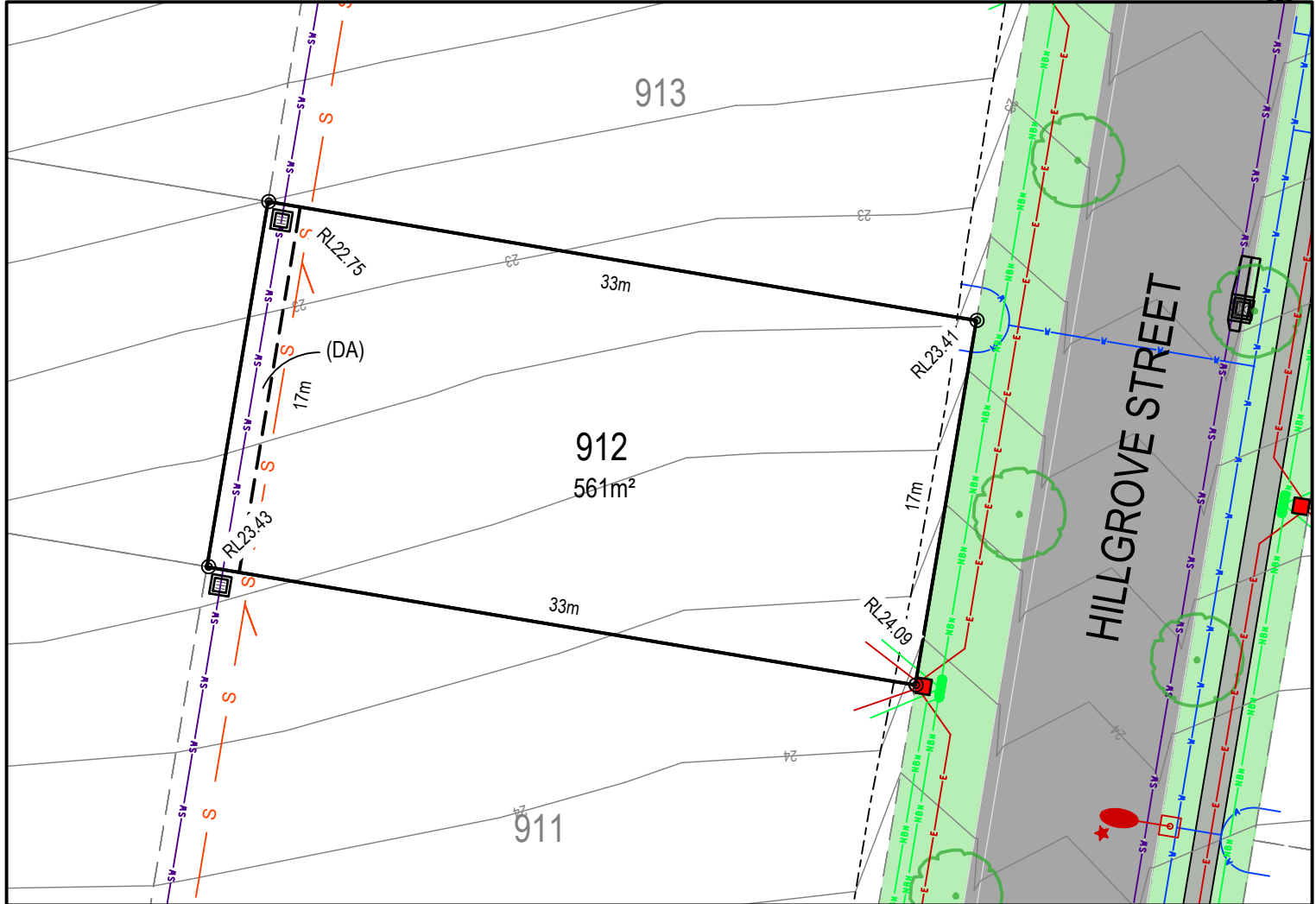

LEGEND:

- BATTER INTERFACE
- RETAINING WALL
- STORMWATER PIT
- SV --- STORMWATER PIPE
- S --- SEWERMAIN
- S --- SEWER MAINTENANCE STRUCTURE
- S --- SEWER JUNCTION
- W --- WATERMAIN
- O X --- HYDRANT, STOP VALVE
- NBN --- TELSTRA / NBN
- NBN --- TELSTRA / NBN PIT
- E --- UNDER GROUND POWER
- E --- ELECTRICITY PILLAR
- E --- ELECTRICAL EASEMENT
- E --- LIGHT POLE
- R --- RESTRICTION ON THE USE OF LAND
- R --- STREET TREES
- R --- ASSET PROTECTION ZONE BDY
- R --- 0.25m CONTOURS

DISCLAIMER/ NOTES:

1. Contours are based on finished design levels and are subject to construction and Council certification and therefore should not be considered as final or as-built.
2. Location of utility services including but not limited to power, water, sewer, communications and gas are subject to construction and supply authority certification and therefore should not be considered as final or as-built.
3. Survey information such as boundary dimensions and areas, easements etc are subject to final survey. Purchasers should refer to the deposited plan and 88B instrument contained in the contract for sale of land for further detailed information.
4. Bushfire and geotechnical classification are provided for convenience. Purchasers should refer to referenced detail specialist reports.
5. This preliminary site analysis plan has been collated from various sources of design information and is provided for convenience to assist purchasers in obtaining quotations/ tenders for dwelling construction.
6. This document does not form part of the contract of sale of the land.
7. Anticipated site classification is H2 or better (to be confirmed at completion of construction).

(DA) - EASEMENT TO DRAIN WATER 1.5 WIDE
(DB) - RESTRICTION ON USE OF LAND 0.9 WIDE
(DC) - RESTRICTION ON THE USE OF LAND 8.5 WIDE

REVISION/S: HD213 STAGE 9 MARKETING r1

DATE: 29th JULY 2021

BY: ACOR CONSULTANTS PTY LTD

thegardensmedowie.com.au



A QUALITY
MCCLOY
GROUP
PROJECT

LOT 913, HILLGROVE STREET, MEDOWIE

MASTER PLAN



STAGE PLAN

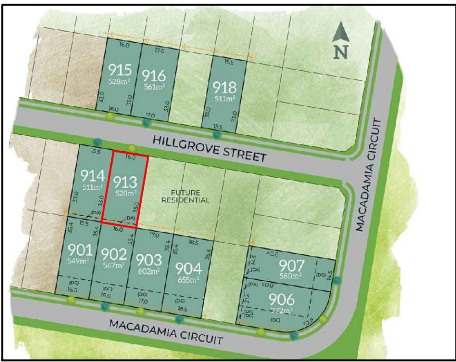

THE GARDENS
MEDOWIE

PRELIMINARY SITE ANALYSIS PLAN

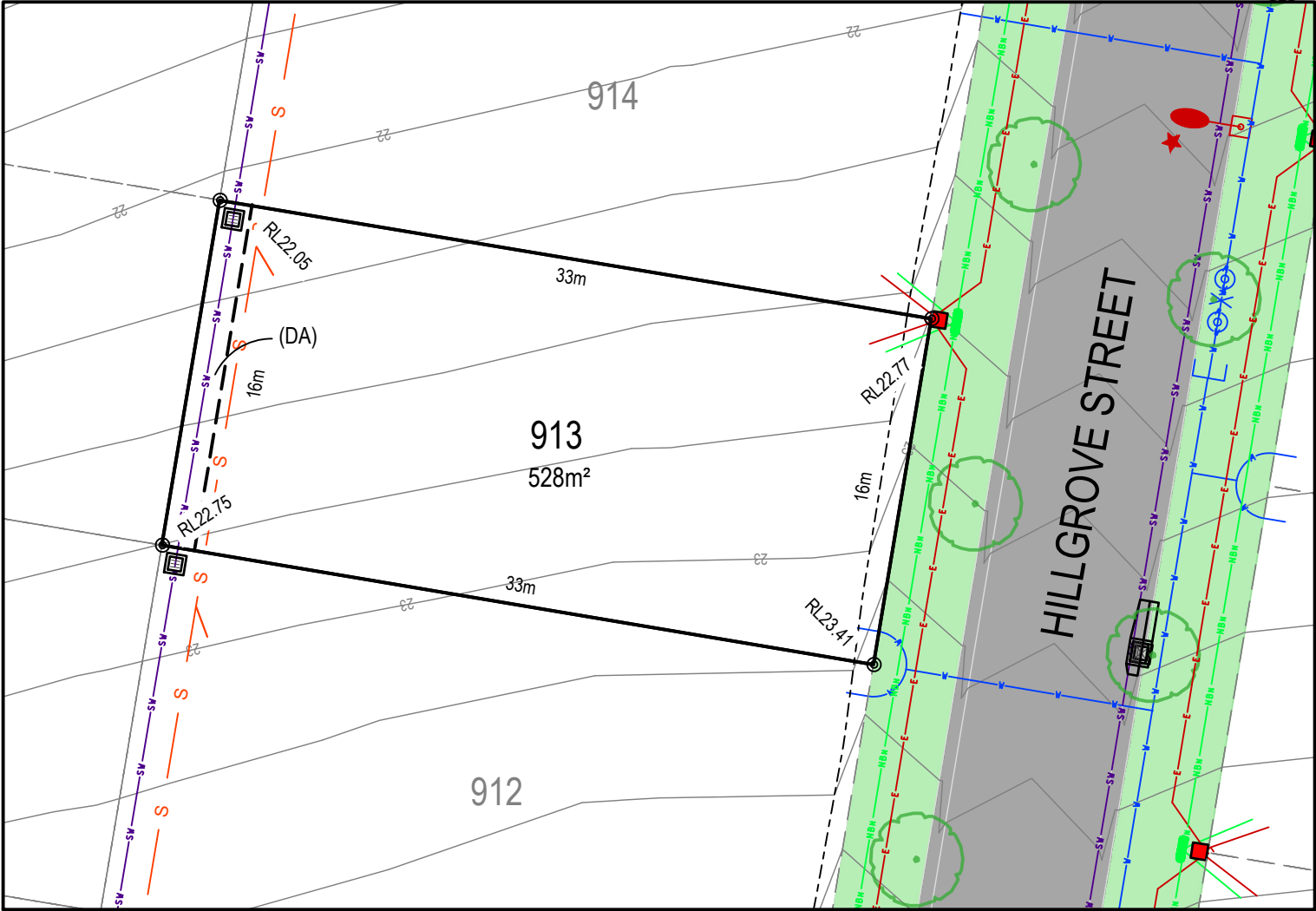

- LEGEND:**
- BATTER INTERFACE
 - RETAINING WALL
 - STORMWATER PIT
 - STORMWATER PIPE
 - SEWERMAIN
 - SEWER MAINTENANCE STRUCTURE
 - SEWER JUNCTION
 - WATERMAIN
 - HYDRANT, STOP VALVE
 - TELSTRA / NBN
 - TELSTRA / NBN PIT
 - UNDER GROUND POWER
 - ELECTRICITY PILLAR
 - ELECTRICAL EASEMENT
 - LIGHT POLE
 - RESTRICTION ON THE USE OF LAND
 - STREET TREES
 - ASSET PROTECTION ZONE BDY
 - 0.25m CONTOURS

DISCLAIMER/ NOTES:

- Contours are based on finished design levels and are subject to construction and Council certification and therefore should not be considered as final or as-built.
- Location of utility services including but not limited to power, water, sewer, communications and gas are subject to construction and supply authority certification and therefore should not be considered as final or as-built.
- Survey information such as boundary dimensions and areas, easements etc are subject to final survey. Purchasers should refer to the deposited plan and 88B instrument contained in the contract for sale of land for further detailed information.
- Bushfire and geotechnical classification are provided for convenience. Purchasers should refer to referenced detail specialist reports.
- This preliminary site analysis plan has been collated from various sources of design information and is provided for convenience to assist purchasers in obtaining quotations/ tenders for dwelling construction.
- This document does not form part of the contract of sale of the land.
- Anticipated site classification is H2 or better (to be confirmed at completion of construction).

(DA) - EASEMENT TO DRAIN WATER 1.5 WIDE
(DB) - RESTRICTION ON USE OF LAND 0.9 WIDE
(DC) - RESTRICTION ON THE USE OF LAND 8.5 WIDE

REVISION/S: HD213 STAGE 9 MARKETING r1
DATE: 16 JULY 2021
BY: ACOR CONSULTANTS PTY LTD

LOT 914 HILLGROVE STREET, MEDOWIE



MASTER PLAN



STAGE PLAN



PRELIMINARY SITE ANALYSIS PLAN

SCALE 1:250 @ A4

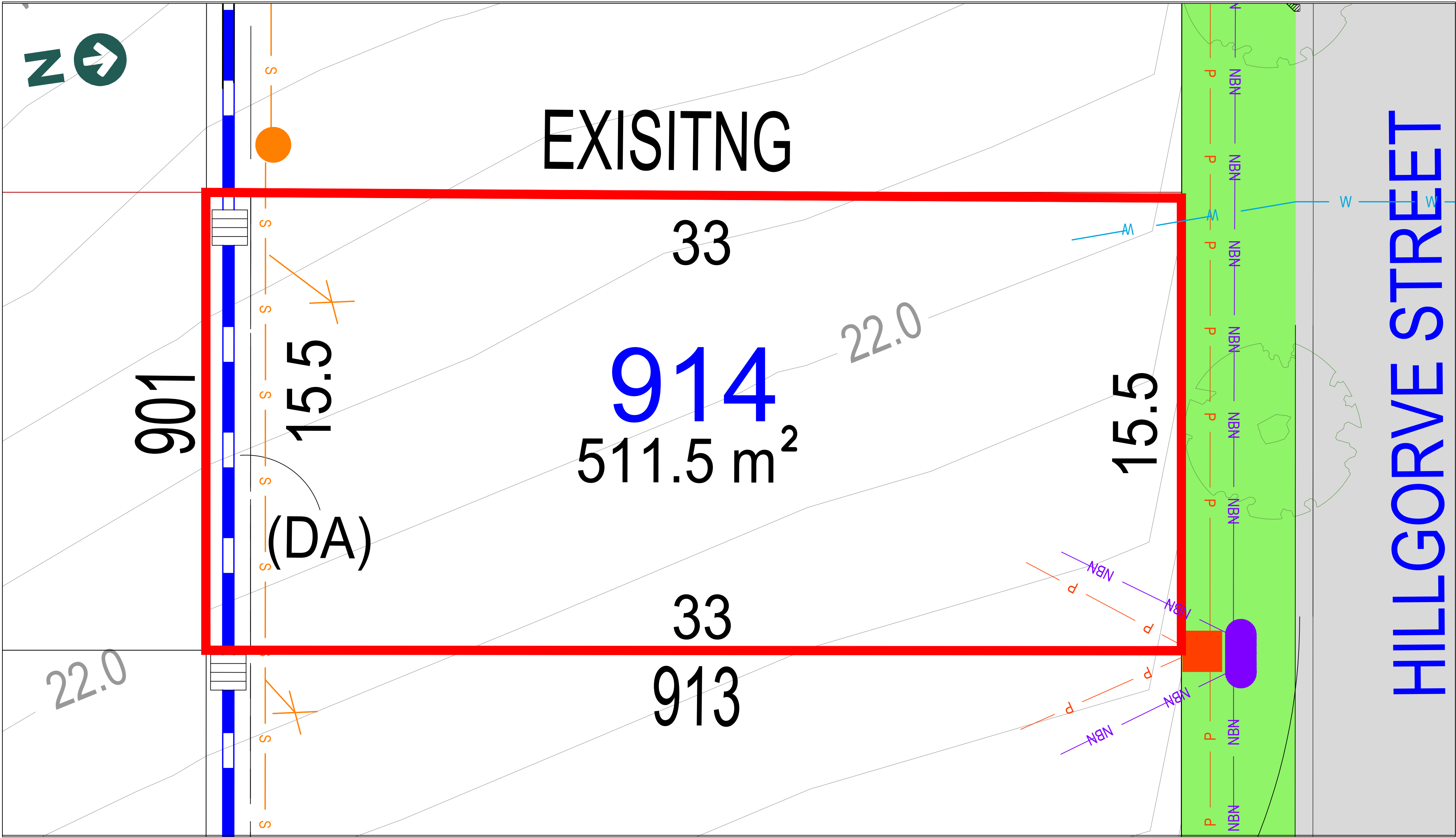
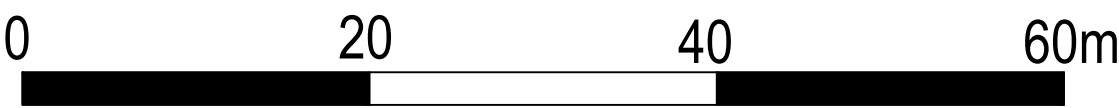

LEGEND:

- TELSTRA /NBN PIT
- HYDRANT
- STOP VALVE
- SEWER MANHOLE
- LIGHT POLE
- KERB INLET PIT
- STORMWATER PIT
- ELECTRICITY PILLAR
- ELECTRICAL SUBSTATION
- STREET TREES
- STORMWATER PIPE
- SEWER JUNCTION
- SEWER MAIN
- WATER MAIN
- TELSTRA /NBN
- UNDER GROUND POWER

Anticipated Site Classification - H1 Class
(to be confirmed at completion of construction)

(DA) EASEMENT TO DRAIN WATER 1.5m WIDE

(BDA) AREA BENEFITED EASEMENT TO DRAIN WATER 1.5m WIDE

(DC) RESTRICTION ON THE USE OF LAND (8.5 WIDE)

DISCLAIMER/ NOTES:

1.

Contours are based on finished design levels and are subject to construction and Council certification and therefore should not be considered as final or as-built.
2.

Location of utility services including but not limited to power, water, sewer, communications and gas are subject to construction and Supply Authority certification and therefore should not be considered as final or as-built.
3.

Survey information such as boundary dimensions and areas, easements etc are subject to Final Survey. Purchasers should refer to the Deposited Plan and 88B Instrument contained in the Contract for Sale of Land for further detailed information.
4.

Bushfire and Geotechnical classification are provided for convenience. Purchasers should refer to referenced detail specialist reports.
5.

This Preliminary Site Analysis Plan has been collated from various sources of design information and is provided for convenience to assist Purchasers in obtaining quotations/tenders for dwelling construction.
6.

This document does not form part of the Contract of Sale of the Land.

REVISION/S: HD213 STAGE 9 MARKETING r1

DATE: 17th OF MAY 2021

BY: HIGH DEFINITION DESIGN PTY LTD

LOT 915 HILLGROVE STREET, MEDOWIE



MASTER PLAN



STAGE PLAN



PRELIMINARY SITE ANALYSIS PLAN

SCALE 1:250 @ A4

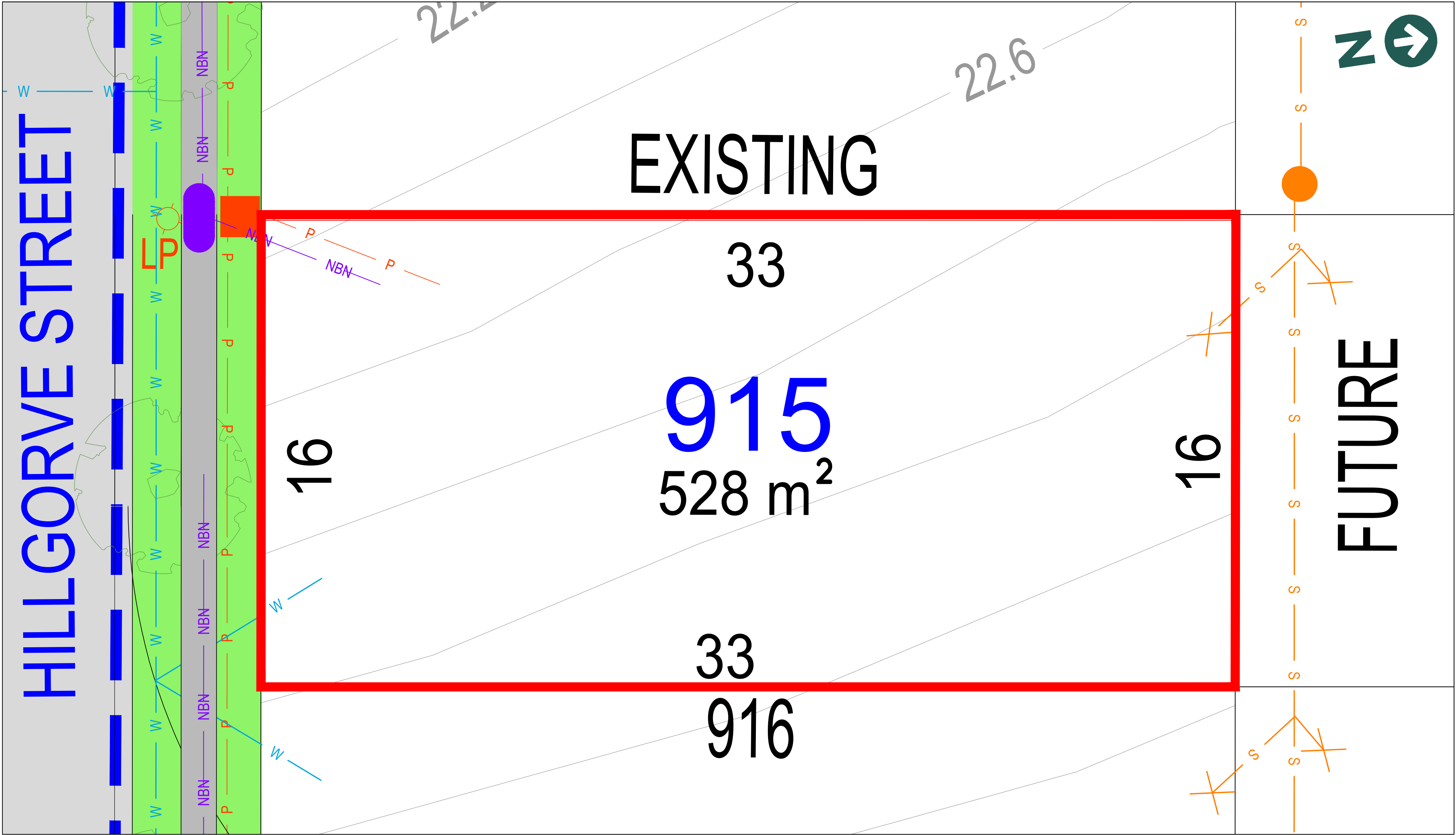
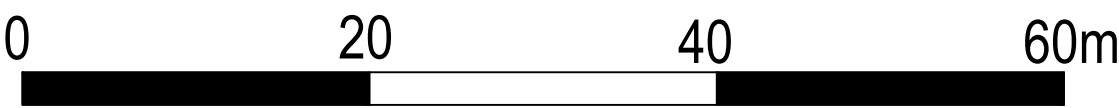

LEGEND:

- TELSTRA /NBN PIT
- HYDRANT
- STOP VALVE
- SEWER MANHOLE
- LIGHT POLE
- KERB INLET PIT
- STORMWATER PIT
- ELECTRICITY PILLAR
- ELECTRICAL SUBSTATION
- STREET TREES

STORMWATER PIPESEWER JUNCTIONSEWER MAINWATER MAINTELSTRA /NBNUNDER GROUND POWER

Anticipated Site Classification - H1 Class
(to be confirmed at completion of construction)

(DA) EASEMENT TO DRAIN WATER 1.5m WIDE

(BDA) AREA BENEFITED EASEMENT TO DRAIN WATER 1.5m WIDE

(DC) RESTRICTION ON THE USE OF LAND (8.5 WIDE)

DISCLAIMER/ NOTES:

1. Contours are based on finished design levels and are subject to construction and Council certification and therefore should not be considered as final or as-built.
2. Location of utility services including but not limited to power, water, sewer, communications and gas are subject to construction and Supply Authority certification and therefore should not be considered as final or as-built.
3. Survey information such as boundary dimensions and areas, easements etc are subject to Final Survey. Purchasers should refer to the Deposited Plan and 88B Instrument contained in the Contract for Sale of Land for further detailed information.
4. Bushfire and Geotechnical classification are provided for convenience. Purchasers should refer to referenced detail specialist reports.
5. This Preliminary Site Analysis Plan has been collated from various sources of design information and is provided for convenience to assist Purchasers in obtaining quotations/tenders for dwelling construction.
6. This document does not form part of the Contract of Sale of the Land.

REVISION/S: HD213 STAGE 9 MARKETING r1

DATE: 17th OF MAY 2021

BY: HIGH DEFINITION DESIGN PTY LTD

LOT 916, HILLGROVE STREET, MEDOWIE

MASTER PLAN



STAGE PLAN

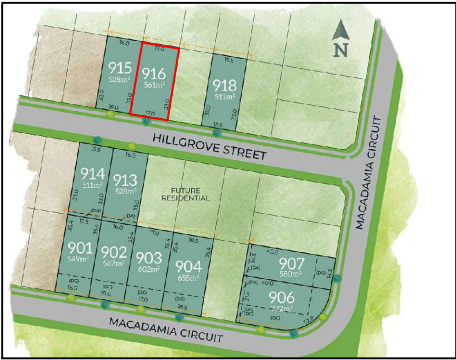

PRELIMINARY SITE ANALYSIS PLAN

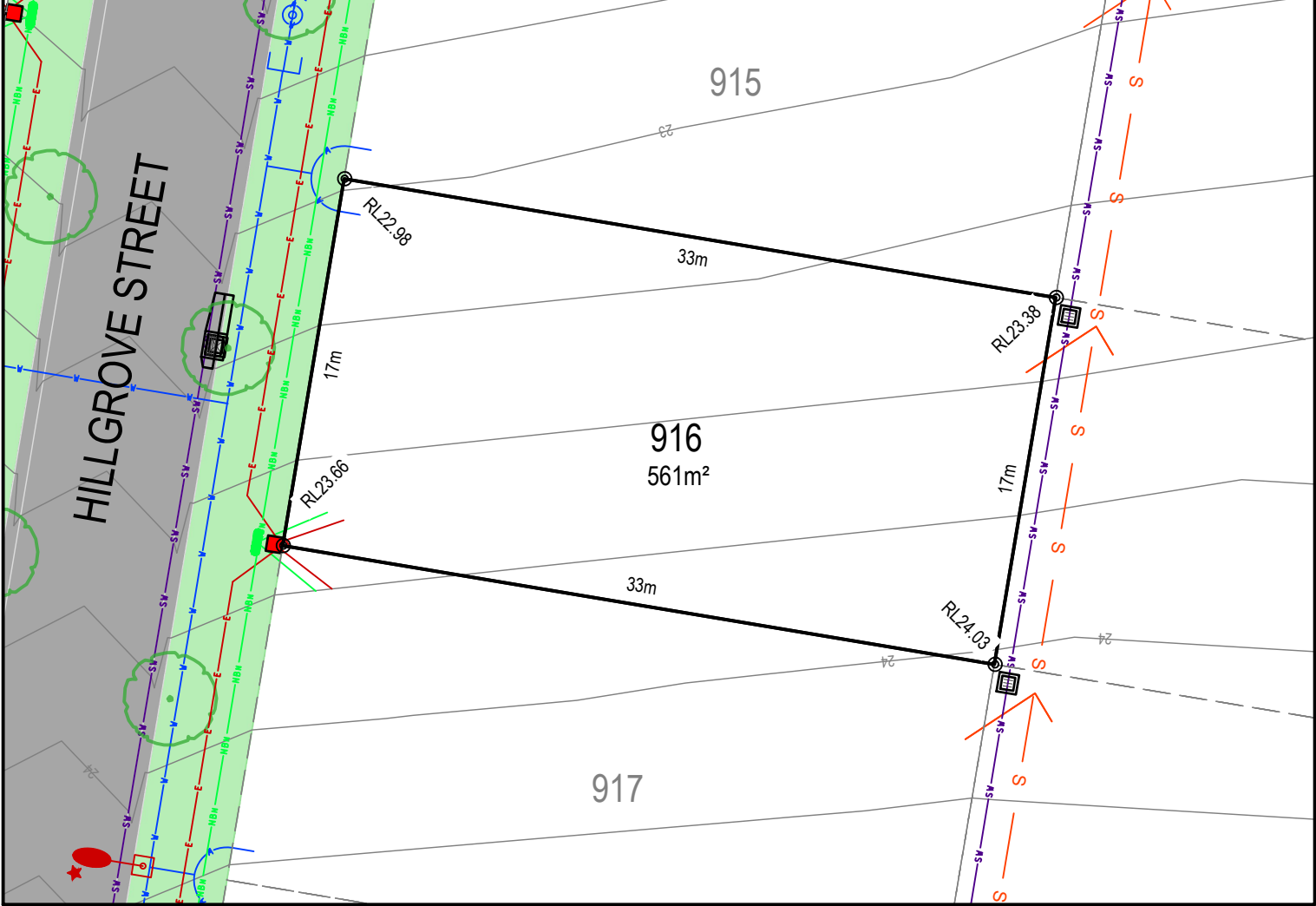

- LEGEND:**
- BATTER INTERFACE
 - RETAINING WALL
 - STORMWATER PIT
 - STORMWATER PIPE
 - SEWERMAIN
 - SEWER MAINTENANCE STRUCTURE
 - SEWER JUNCTION
 - WATERMAIN
 - HYDRANT, STOP VALVE
 - TELSTRA / NBN
 - TELSTRA / NBN PIT
 - UNDER GROUND POWER
 - ELECTRICITY PILLAR
 - ELECTRICAL EASEMENT
 - LIGHT POLE
 - RESTRICTION ON THE USE OF LAND
 - STREET TREES
 - ASSET PROTECTION ZONE BDY
 - 0.25m CONTOURS

DISCLAIMER/ NOTES:

- Contours are based on finished design levels and are subject to construction and Council certification and therefore should not be considered as final or as-built.
- Location of utility services including but not limited to power, water, sewer, communications and gas are subject to construction and supply authority certification and therefore should not be considered as final or as-built.
- Survey information such as boundary dimensions and areas, easements etc are subject to final survey. Purchasers should refer to the deposited plan and 88B instrument contained in the contract for sale of land for further detailed information.
- Bushfire and geotechnical classification are provided for convenience. Purchasers should refer to referenced detail specialist reports.
- This preliminary site analysis plan has been collated from various sources of design information and is provided for convenience to assist purchasers in obtaining quotations/ tenders for dwelling construction.
- This document does not form part of the contract of sale of the land.
- Anticipated site classification is H2 or better (to be confirmed at completion of construction).

(DA) - EASEMENT TO DRAIN WATER 1.5 WIDE
(DB) - RESTRICTION ON USE OF LAND 0.9 WIDE
(DC) - RESTRICTION ON THE USE OF LAND 8.5 WIDE

REVISION/S: HD213 STAGE 9 MARKETING r1
DATE: 16 JULY 2021
BY: ACOR CONSULTANTS PTY LTD

LOT 917, HILLGROVE STREET, MEDOWIE

MASTER PLAN



STAGE PLAN

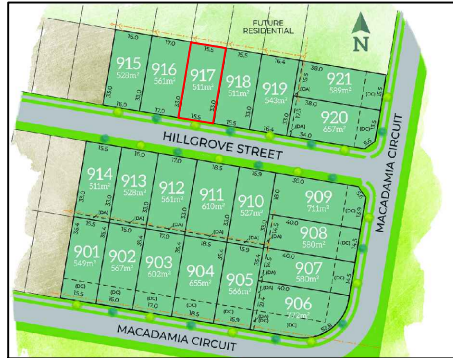

THE GARDENS
MEDOWIE

PRELIMINARY SITE ANALYSIS PLAN

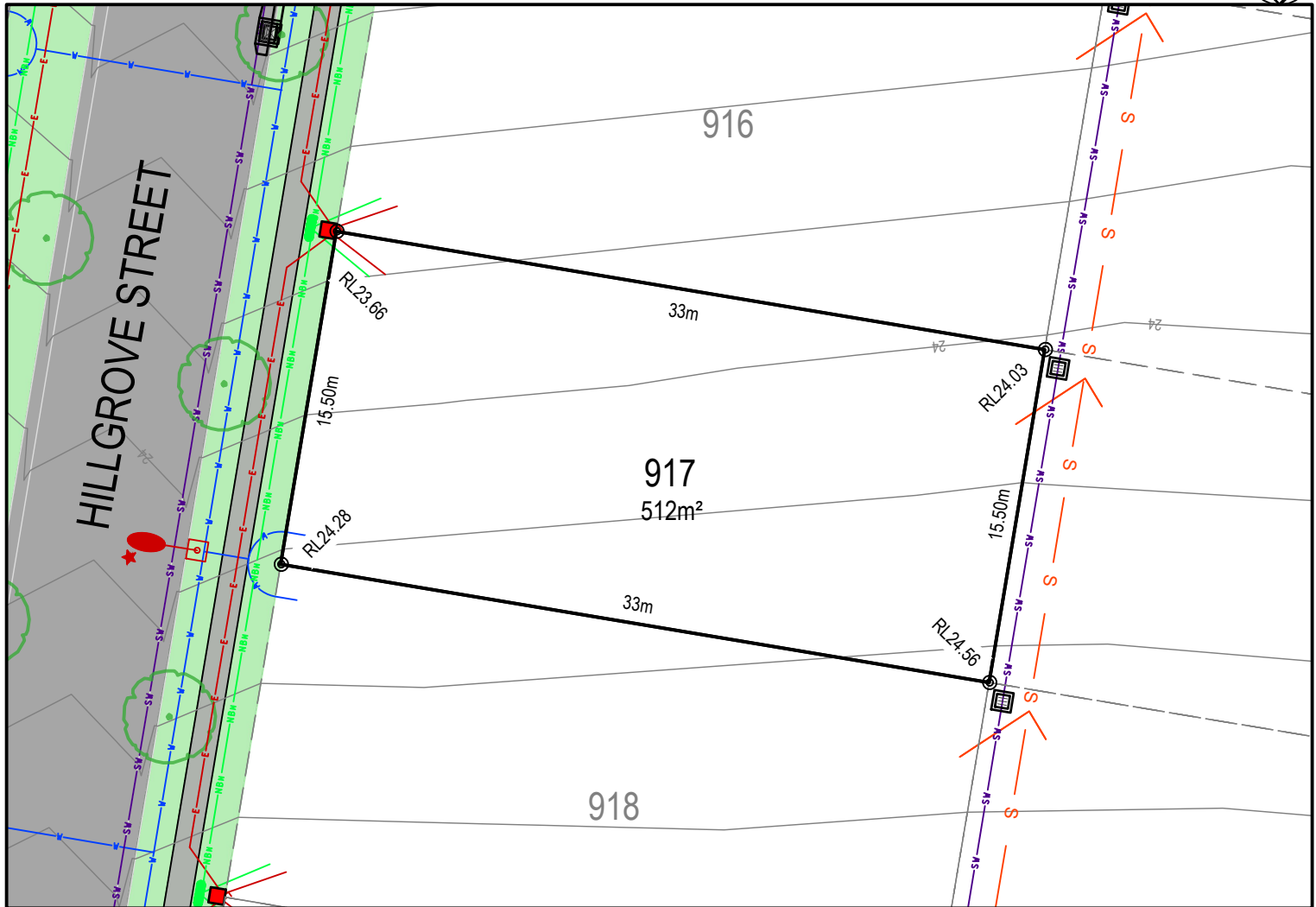

LEGEND:

- BATTER INTERFACE
- RETAINING WALL
- STORMWATER PIT
- SV --- STORMWATER PIPE
- S --- SEWERMAIN
- S --- SEWER MAINTENANCE STRUCTURE
- S --- SEWER JUNCTION
- W --- WATERMAIN
- O X --- HYDRANT, STOP VALVE
- NBW --- TELSTRA / NBN
- TELSTRA / NBN PIT
- E --- UNDER GROUND POWER
- ELECTRICITY PILLAR
- ELECTRICAL EASEMENT
- LIGHT POLE
- RESTRICTION ON THE USE OF LAND
- STREET TREES
- ASSET PROTECTION ZONE BDY
- 0.25m CONTOURS

DISCLAIMER/ NOTES:

- Contours are based on finished design levels and are subject to construction and Council certification and therefore should not be considered as final or as-built.
- Location of utility services including but not limited to power, water, sewer, communications and gas are subject to construction and supply authority certification and therefore should not be considered as final or as-built.
- Survey information such as boundary dimensions and areas, easements etc are subject to final survey. Purchasers should refer to the deposited plan and 88B instrument contained in the contract for sale of land for further detailed information.
- Bushfire and geotechnical classification are provided for convenience. Purchasers should refer to referenced detail specialist reports.
- This preliminary site analysis plan has been collated from various sources of design information and is provided for convenience to assist purchasers in obtaining quotations/ tenders for dwelling construction.
- This document does not form part of the contract of sale of the land.
- Anticipated site classification is H2 or better (to be confirmed at completion of construction).

(DA) - EASEMENT TO DRAIN WATER 1.5 WIDE
(DB) - RESTRICTION ON USE OF LAND 0.9 WIDE
(DC) - RESTRICTION ON THE USE OF LAND 8.5 WIDE

REVISION/S: HD213 STAGE 9 MARKETING r1
DATE: 29th JULY 2021
BY: ACOR CONSULTANTS PTY LTD

thegardensmedowie.com.au



A QUALITY
MCCLOY
GROUP
PROJECT

LOT 918, HILLGROVE STREET, MEDOWIE

MASTER PLAN



STAGE PLAN

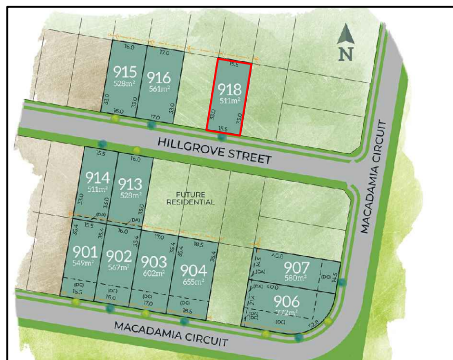

THE GARDENS
MEDOWIE

PRELIMINARY SITE ANALYSIS PLAN

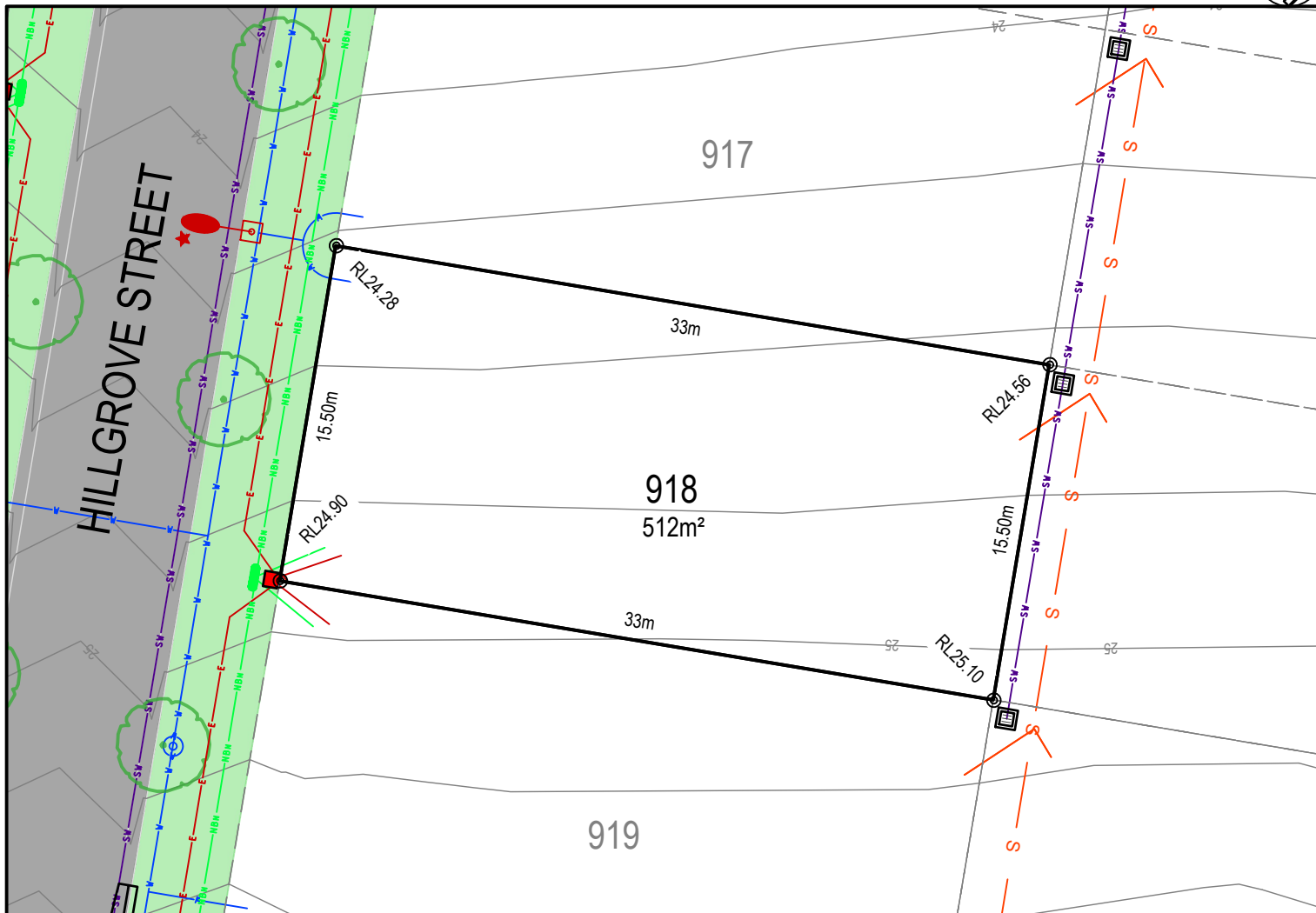

LEGEND:

- BATTER INTERFACE
- RETAINING WALL
- STORMWATER PIT
- SV --- STORMWATER PIPE
- S --- SEWERMAIN
- S --- SEWER MAINTENANCE STRUCTURE
- S --- SEWER JUNCTION
- W --- WATERMAIN
- O X --- HYDRANT, STOP VALVE
- NBW --- TELSTRA / NBN
- TELSTRA / NBN PIT
- E --- UNDER GROUND POWER
- ELECTRICITY PILLAR
- ELECTRICAL EASEMENT
- LIGHT POLE
- RESTRICTION ON THE USE OF LAND
- STREET TREES
- ASSET PROTECTION ZONE BDY
- 0.25m CONTOURS

DISCLAIMER/ NOTES:

1. Contours are based on finished design levels and are subject to construction and Council certification and therefore should not be considered as final or as-built.
2. Location of utility services including but not limited to power, water, sewer, communications and gas are subject to construction and supply authority certification and therefore should not be considered as final or as-built.
3. Survey information such as boundary dimensions and areas, easements etc are subject to final survey. Purchasers should refer to the deposited plan and 88B instrument contained in the contract for sale of land for further detailed information.
4. Bushfire and geotechnical classification are provided for convenience. Purchasers should refer to referenced detail specialist reports.
5. This preliminary site analysis plan has been collated from various sources of design information and is provided for convenience to assist purchasers in obtaining quotations/ tenders for dwelling construction.
6. This document does not form part of the contract of sale of the land.
7. Anticipated site classification is H2 or better (to be confirmed at completion of construction).

(DA) - EASEMENT TO DRAIN WATER 1.5 WIDE
(DB) - RESTRICTION ON USE OF LAND 0.9 WIDE
(DC) - RESTRICTION ON THE USE OF LAND 8.5 WIDE

REVISION/S: HD213 STAGE 9 MARKETING r1
DATE: 16 JULY 2021
BY: ACOR CONSULTANTS PTY LTD

thegardensmedowie.com.au



A QUALITY
MCCLOY
GROUP
PROJECT

LOT 919, HILLGROVE STREET, MEDOWIE

MASTER PLAN



STAGE PLAN



THE GARDENS
MEDOWIE

PRELIMINARY SITE ANALYSIS PLAN



LEGEND:

---	BATTER INTERFACE
—	RETAINING WALL
■	STORMWATER PIT
—SV—	STORMWATER PIPE
—S—	SEWERMAIN
○	SEWER MAINTENANCE STRUCTURE
—S—	SEWER JUNCTION
—V—	WATERMAIN
○ X	HYDRANT, STOP VALVE
—NBW—	TELSTRA / NBN
—	TELSTRA / NBN PIT
—E—	UNDER GROUND POWER
■	ELECTRICITY PILLAR
—	ELECTRICAL EASEMENT
—	LIGHT POLE
—	RESTRICTION ON THE USE OF LAND
○	STREET TREES
—	ASSET PROTECTION ZONE BDY
—	0.25m CONTOURS

DISCLAIMER/ NOTES:

1. Contours are based on finished design levels and are subject to construction and Council certification and therefore should not be considered as final or as-built.
2. Location of utility services including but not limited to power, water, sewer, communications and gas are subject to construction and supply authority certification and therefore should not be considered as final or as-built.
3. Survey information such as boundary dimensions and areas, easements etc are subject to final survey. Purchasers should refer to the deposited plan and 88B instrument contained in the contract for sale of land for further detailed information.
4. Bushfire and geotechnical classification are provided for convenience. Purchasers should refer to referenced detail specialist reports.
5. This preliminary site analysis plan has been collated from various sources of design information and is provided for convenience to assist purchasers in obtaining quotations/ tenders for dwelling construction.
6. This document does not form part of the contract of sale of the land.
7. Anticipated site classification is H2 or better (to be confirmed at completion of construction).

(DA) - EASEMENT TO DRAIN WATER 1.5 WIDE
(DB) - RESTRICTION ON USE OF LAND 0.9 WIDE
(DC) - RESTRICTION ON THE USE OF LAND 8.5 WIDE

REVISION/S: HD213 STAGE 9 MARKETING r1
DATE: 29th JULY 2021
BY: ACOR CONSULTANTS PTY LTD

thegardensmedowie.com.au



A QUALITY
MCCLOY
GROUP
PROJECT

LOT 920, MACADAMIA CIRCUIT, MEDOWIE

MASTER PLAN



STAGE PLAN

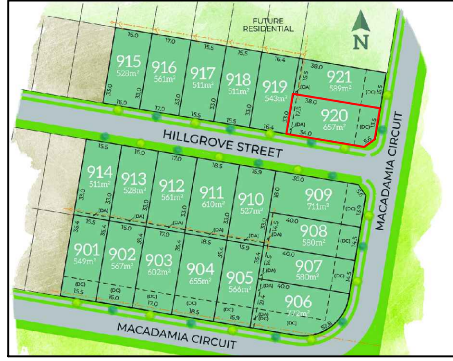

THE GARDENS
MEDOWIE



PRELIMINARY SITE ANALYSIS PLAN

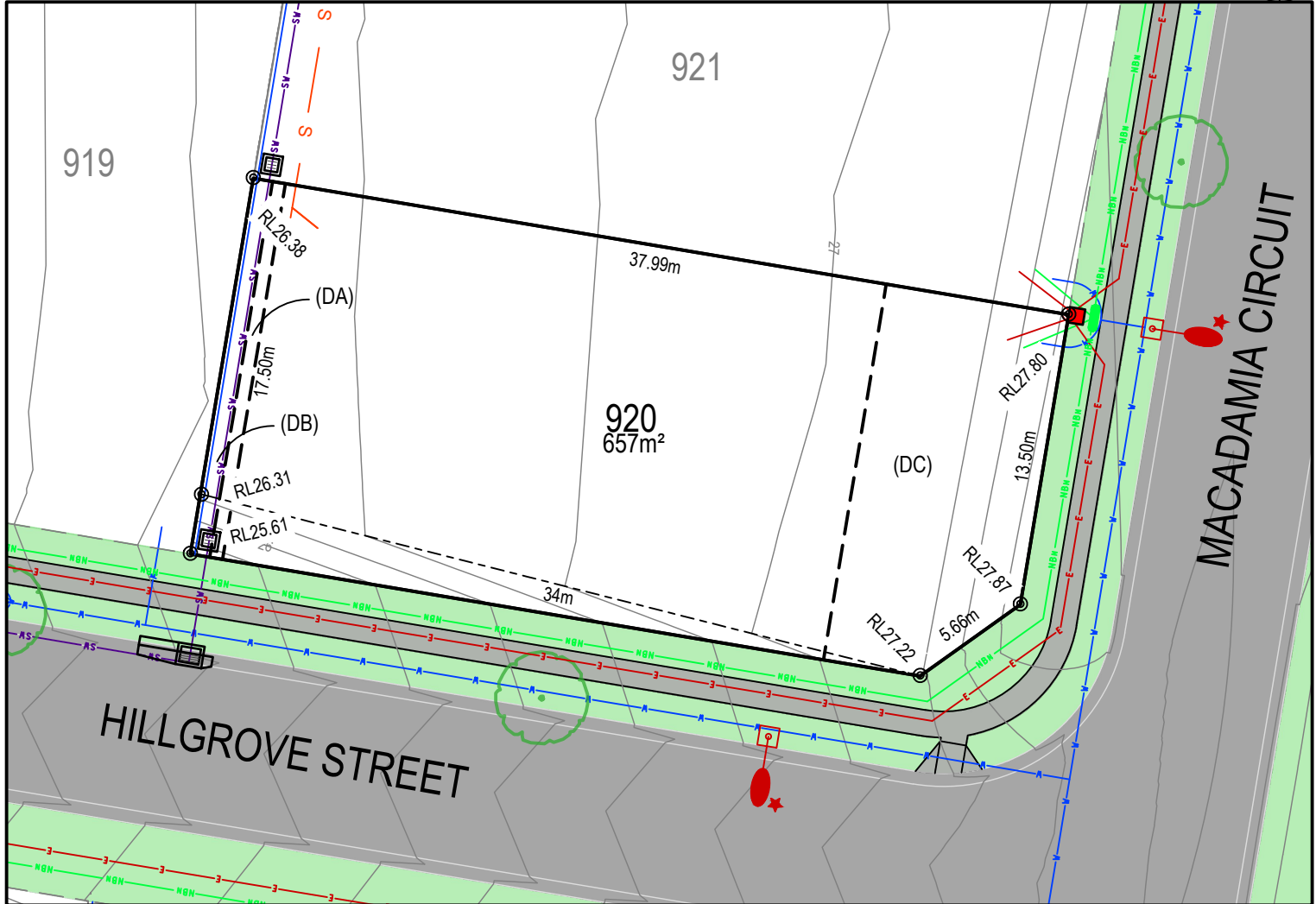

LEGEND:

- BATTER INTERFACE
- RETAINING WALL
- STORMWATER PIT
- SV --- STORMWATER PIPE
- S --- SEWERMAIN
- S --- SEWER MAINTENANCE STRUCTURE
- S --- SEWER JUNCTION
- W --- WATERMAIN
- O --- HYDRANT, STOP VALVE
- NBN --- TELSTRA / NBN
- NBN --- TELSTRA / NBN PIT
- E --- UNDER GROUND POWER
- E --- ELECTRICITY PILLAR
- E --- ELECTRICAL EASEMENT
- E --- LIGHT POLE
- R --- RESTRICTION ON THE USE OF LAND
- S --- STREET TREES
- AS --- ASSET PROTECTION ZONE BDY
- 0.25m CONTOURS

DISCLAIMER/ NOTES:

1. Contours are based on finished design levels and are subject to construction and Council certification and therefore should not be considered as final or as-built.
2. Location of utility services including but not limited to power, water, sewer, communications and gas are subject to construction and supply authority certification and therefore should not be considered as final or as-built.
3. Survey information such as boundary dimensions and areas, easements etc are subject to final survey. Purchasers should refer to the deposited plan and 88B instrument contained in the contract for sale of land for further detailed information.
4. Bushfire and geotechnical classification are provided for convenience. Purchasers should refer to referenced detail specialist reports.
5. This preliminary site analysis plan has been collated from various sources of design information and is provided for convenience to assist purchasers in obtaining quotations/ tenders for dwelling construction.
6. This document does not form part of the contract of sale of the land.
7. Anticipated site classification is H2 or better (to be confirmed at completion of construction).

(DA) - EASEMENT TO DRAIN WATER 1.5 WIDE
(DB) - RESTRICTION ON USE OF LAND 0.9 WIDE
(DC) - RESTRICTION ON THE USE OF LAND 8.5 WIDE

REVISION/S: HD213 STAGE 9 MARKETING r1

DATE: 29th JULY 2021

BY: ACOR CONSULTANTS PTY LTD

thegardensmedowie.com.au



A QUALITY
MCCLOY
GROUP
PROJECT

LOT 921, MACADAMIA CIRCUIT, MEDOWIE

MASTER PLAN



STAGE PLAN

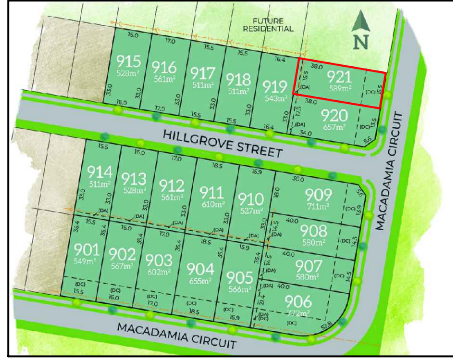

THE GARDENS
MEDOWIE

PRELIMINARY SITE ANALYSIS PLAN

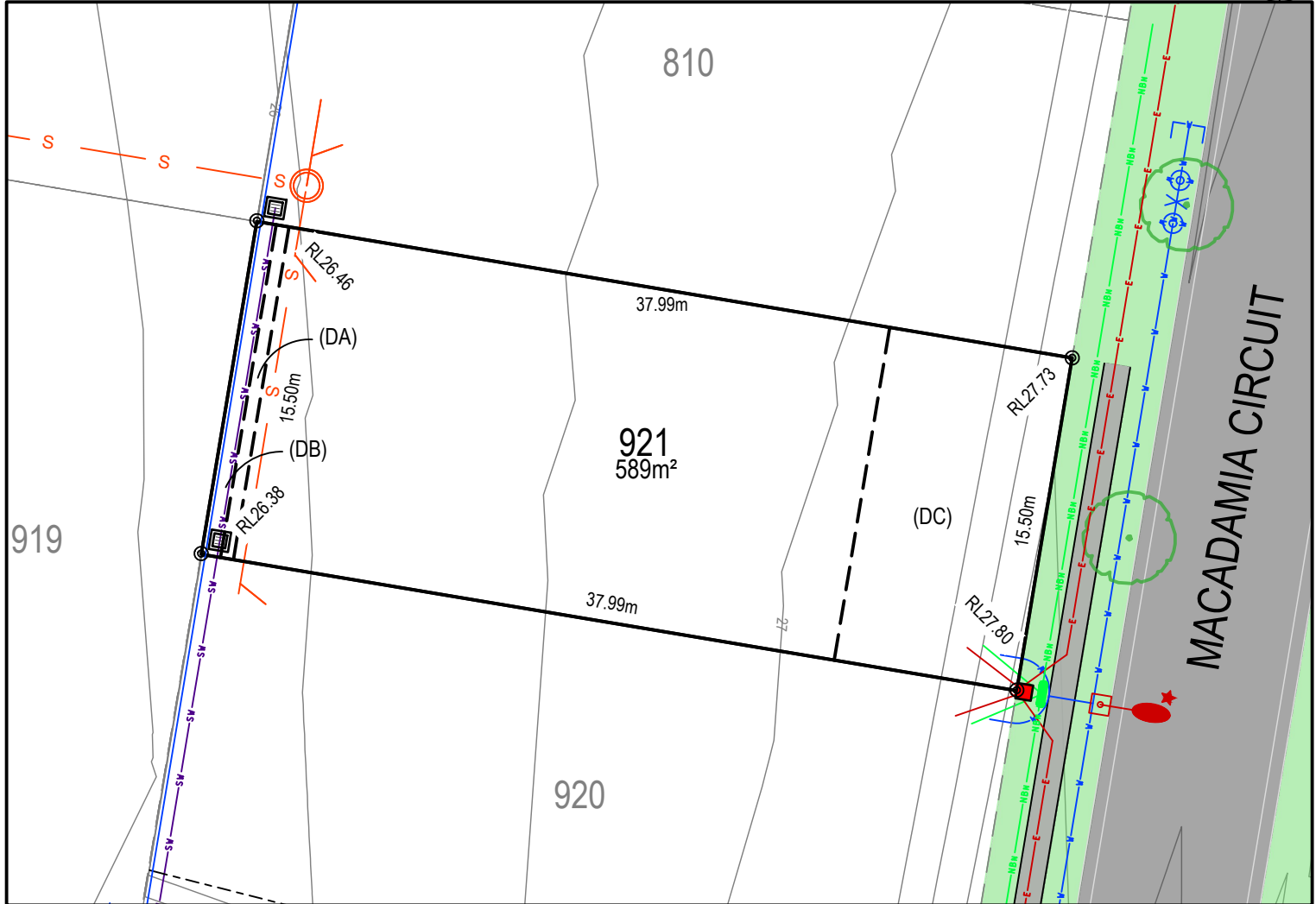

LEGEND:

- BATTER INTERFACE
- RETAINING WALL
- STORMWATER PIT
- SV --- STORMWATER PIPE
- S --- SEWERMAIN
- S --- SEWER MAINTENANCE STRUCTURE
- S --- SEWER JUNCTION
- W --- WATERMAIN
- O X --- HYDRANT, STOP VALVE
- NBN --- TELSTRA / NBN
- NBN --- TELSTRA / NBN PIT
- E --- UNDER GROUND POWER
- E --- ELECTRICITY PILLAR
- E --- ELECTRICAL EASEMENT
- E --- LIGHT POLE
- RESTRICTION ON THE USE OF LAND
- STREET TREES
- ASSET PROTECTION ZONE BDY
- 0.25m CONTOURS

DISCLAIMER/ NOTES:

1. Contours are based on finished design levels and are subject to construction and Council certification and therefore should not be considered as final or as-built.
2. Location of utility services including but not limited to power, water, sewer, communications and gas are subject to construction and supply authority certification and therefore should not be considered as final or as-built.
3. Survey information such as boundary dimensions and areas, easements etc are subject to final survey. Purchasers should refer to the deposited plan and 88B instrument contained in the contract for sale of land for further detailed information.
4. Bushfire and geotechnical classification are provided for convenience. Purchasers should refer to referenced detail specialist reports.
5. This preliminary site analysis plan has been collated from various sources of design information and is provided for convenience to assist purchasers in obtaining quotations/ tenders for dwelling construction.
6. This document does not form part of the contract of sale of the land.
7. Anticipated site classification is H2 or better (to be confirmed at completion of construction).

(DA) - EASEMENT TO DRAIN WATER 1.5 WIDE
(DB) - RESTRICTION ON USE OF LAND 0.9 WIDE
(DC) - RESTRICTION ON THE USE OF LAND 8.5 WIDE

REVISION/S: HD213 STAGE 9 MARKETING r1
DATE: 29th JULY 2021
BY: ACOR CONSULTANTS PTY LTD

thegardensmedowie.com.au



A QUALITY
MCCLOY
GROUP
PROJECT